

 **agama**

www.agama-rc.com

**1 / 8 Scale 4WD Nitro
Offroad Buggy**

ABEVO

Instruction Manual

AGAMA 1/8-scale 4WD Nitro Buggy designed with the whole new concept. No matter you are the top driver or fans of RC car, it will let you feel satisfied.

Made in Taiwan

INTRODUCTION	01
CAUTION	02
BAG A Front Diff Installation	03
BAG A Rear Diff Installation	04
BAG A Center Diff Installation	05
BAG B Shock Install (Front & Rear)	06-07
BAG C Front Spindle & CV Installation	08
BAG D Front End Installation	09-12
BAG E Rear Hub & CV Installation	13
BAG F Rear End Installation	14-17
BAG G Center Diff/Brake Installation	18-19
BAG H Switch/Antenna tube Installation	20-23
BAG I Clutch Assembly	23-24
BAG I Clutch Bell Assembly	24
BAG I Engine Mount Assembly	25
BAG J Servo Saver Installation	26
BAG J Steering Servo Link Assembly	26
BAG J Steering Post & Front Chassis Support Assembly	27
BAG J Steering Saver & Front Chassis Brace Assembly	27
BAG J Completed Steering Assembly	28
BAG K Chassis Guard Installation	28
BAG L Throttle/Brake Linkage Assembly	29
BAG L Completed Throttle/Brake Assembly	29
BAG M Air Filter Assembly	30
CHASSIS INSTALLATION	31-38
FACTORY SETUP SHEET	39-40
PART LIST	41-42

Notice: The following items are needed for completion of the PRO KIT, They are not included with this kit (unless noted), and should be obtained from your local hobby shop.

Be sure to read the instructions completely prior to assembly.

ADDITIONAL ITEMS NEEDED FOR COMPLETION

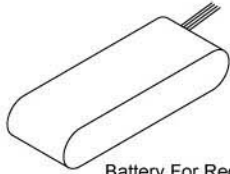

Battery For Receiver

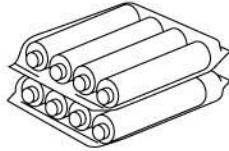

Battery For Transmitter

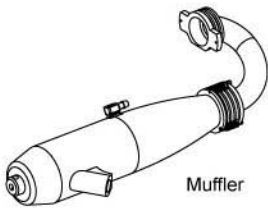

Muffler

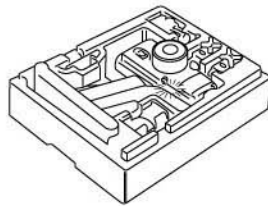

2 Channel Radio

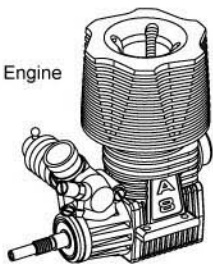

Engine

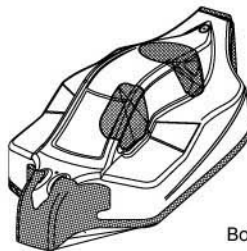

Body

TOOLS NEEDED TO ASSEMBLE

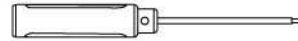

Hex Wrenches

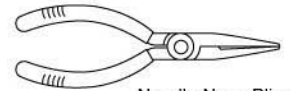

Needle Nose Pliers

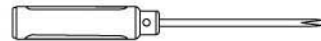

Phillips Type Screw Driver



Scissors

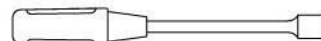

Box Wrench(5.5mm / 7mm / 10mm)



Hobby Knife

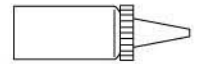

Instant Glue

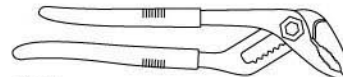

Pliers

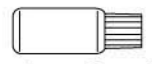

Screw (Sement)

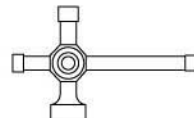

Utility Wrench



Glass or Vinyl Tape

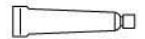

Rubber Glue

ADDITIONAL ITEMS NEEDED FOR STARTING ENGINE

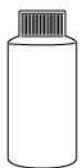

Air Filter Oil



Fuel Pump

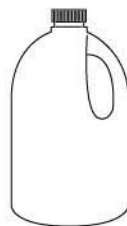

Fuel

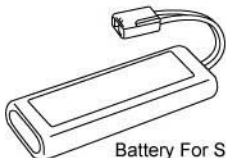

Battery For Starter Box

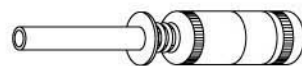

Glow Plug Ignitor

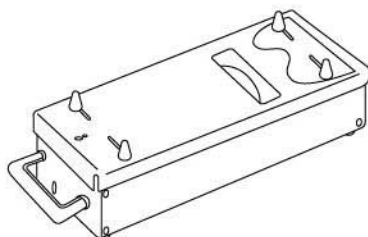

Starter Box

ITEMS NEEDED TO CONTROL CAR

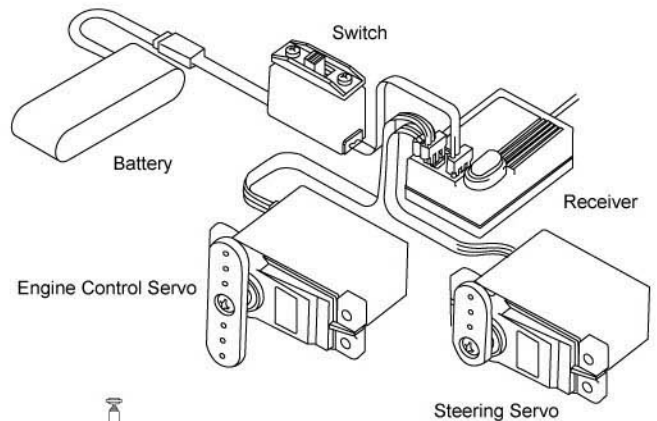

Transmitter

STEP A-1

Front Diff Installation

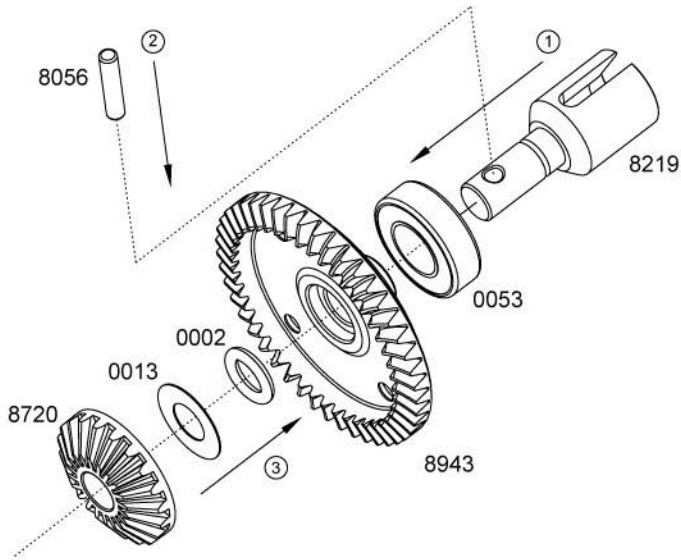

STEP A-3

Front Diff Installation

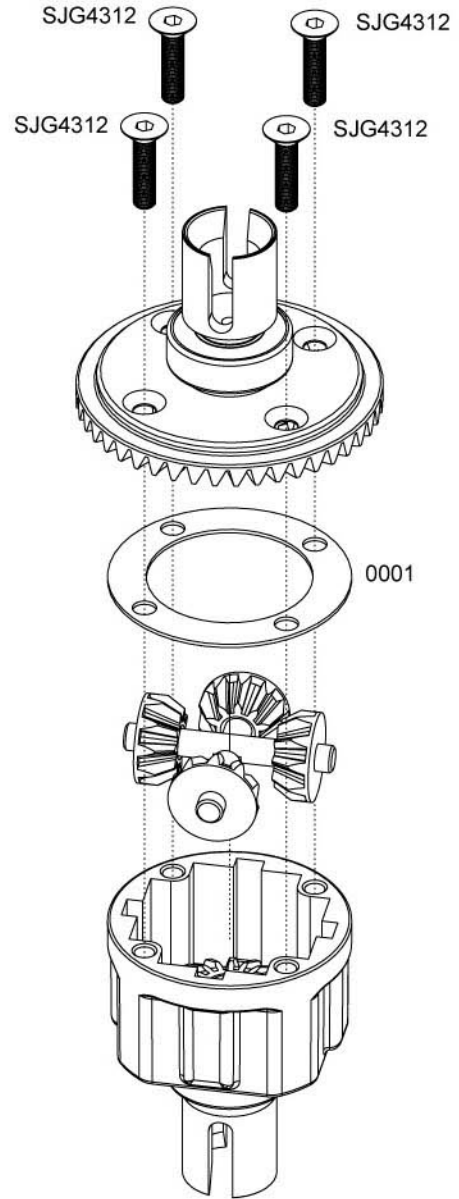

STEP A-2

Front Diff Installation

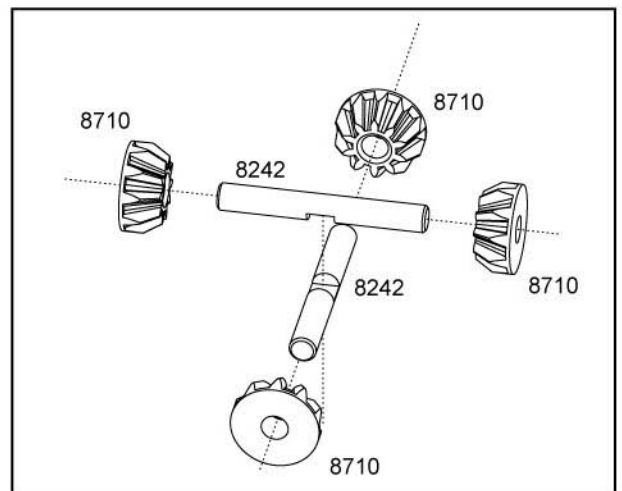
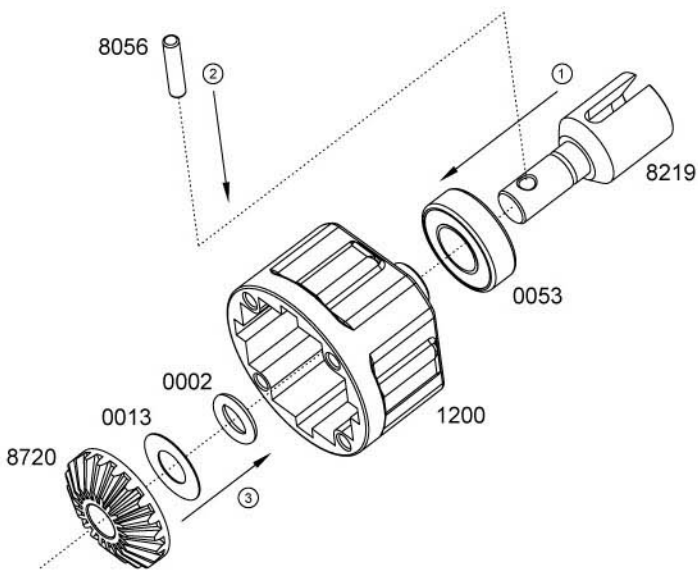

STEP A-4

Rear Diff Installation

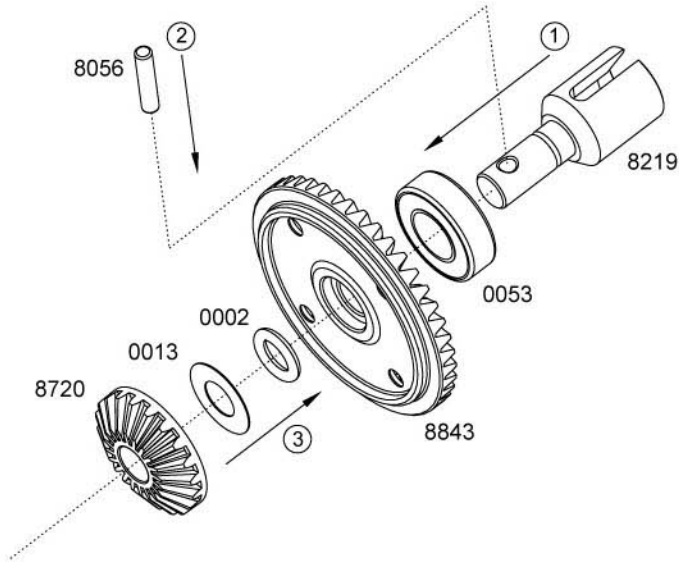

STEP A-5

Rear Diff Installation

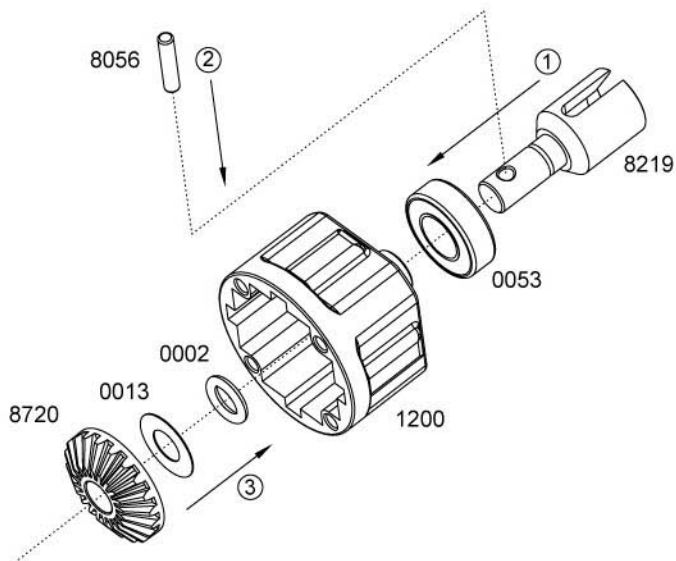

STEP A-6

Rear Diff Installation

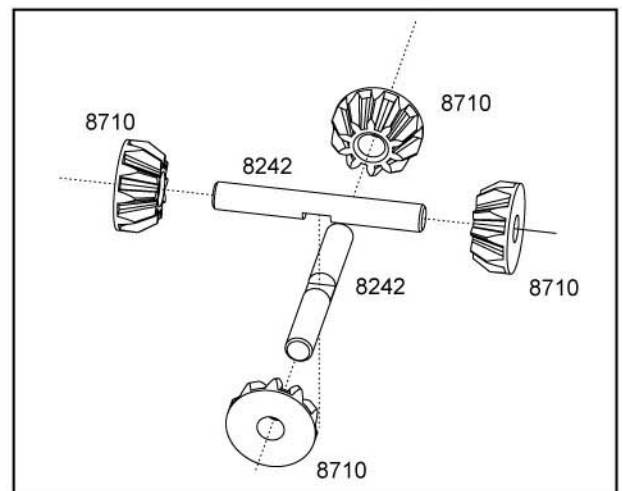
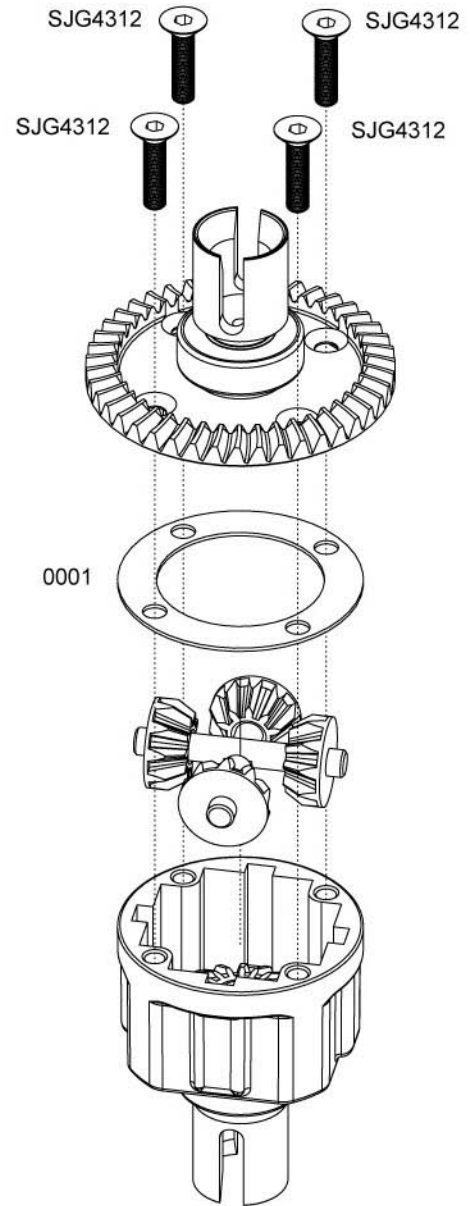

STEP A-7

Center Diff Installation

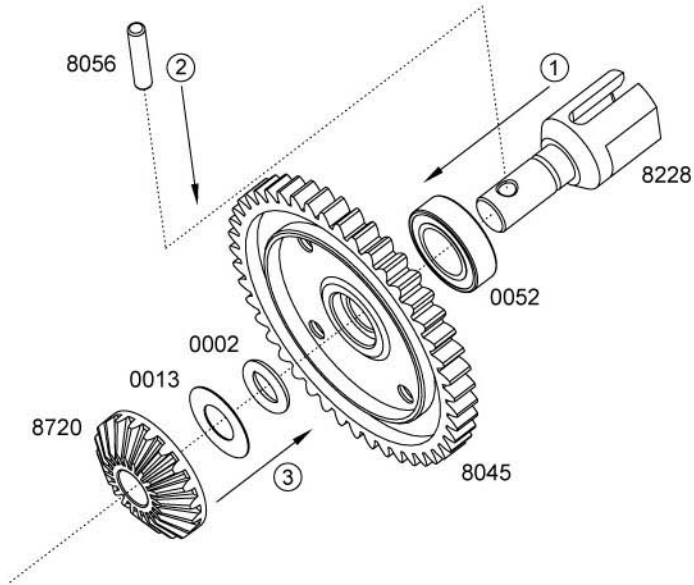

STEP A-9

Center Diff Installation

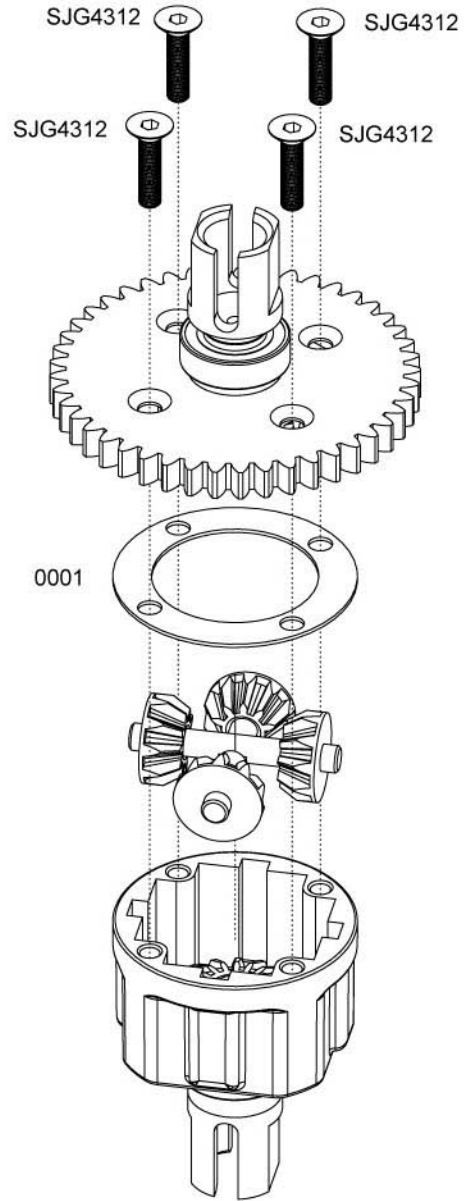

STEP A-8

Center Diff Installation

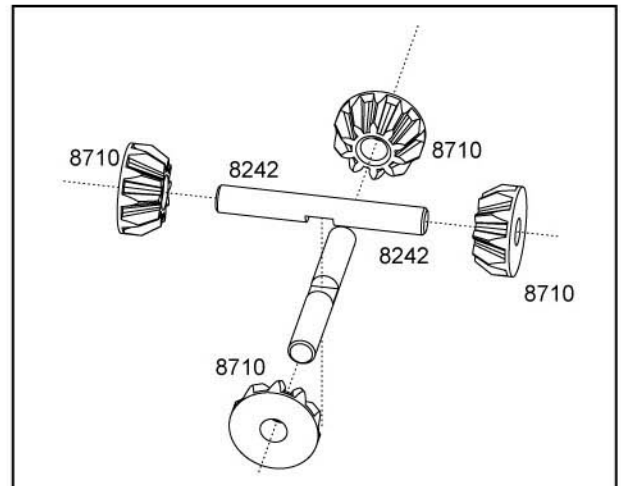
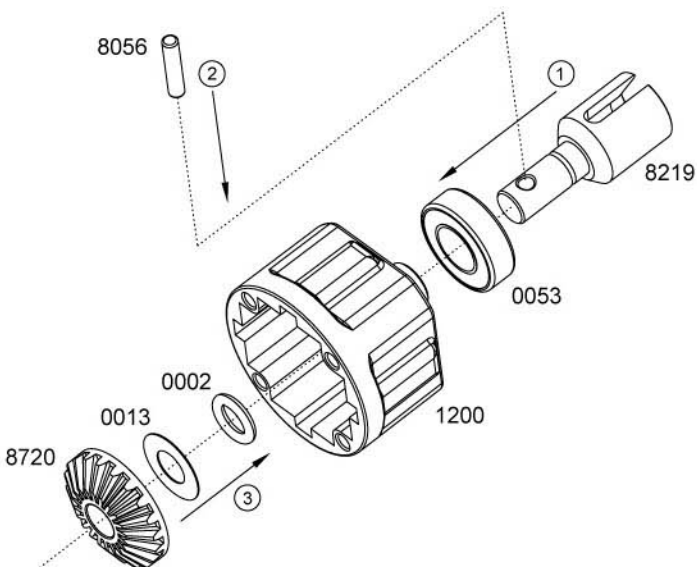

STEP B-1

Shock Install (Front & Rear)

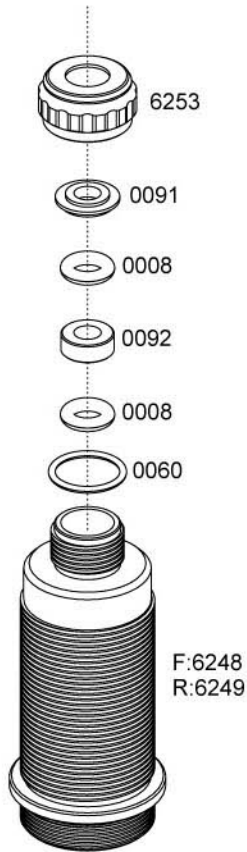

STEP B-2

Shock Install (Front & Rear)



STEP B-3

Shock Install (Front & Rear)

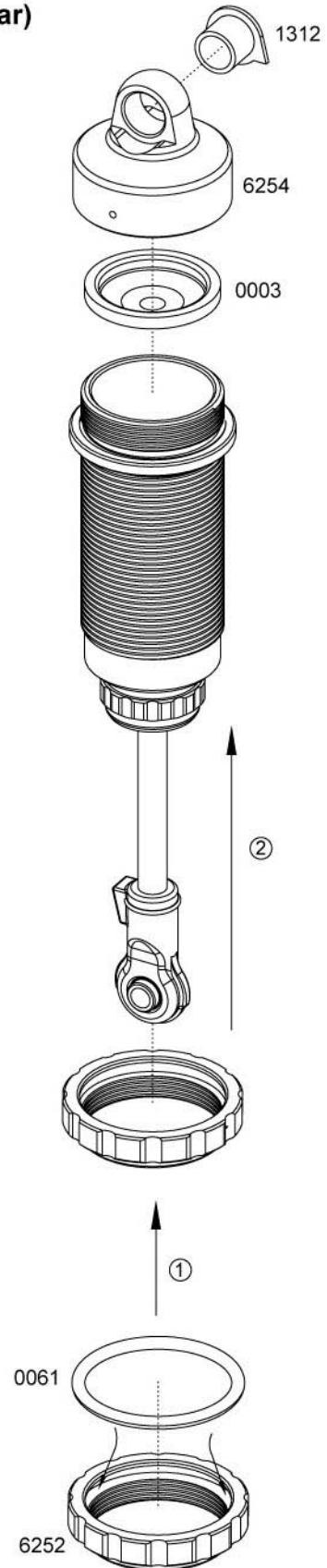

STEP B-4

Shock Install (Front & Rear)

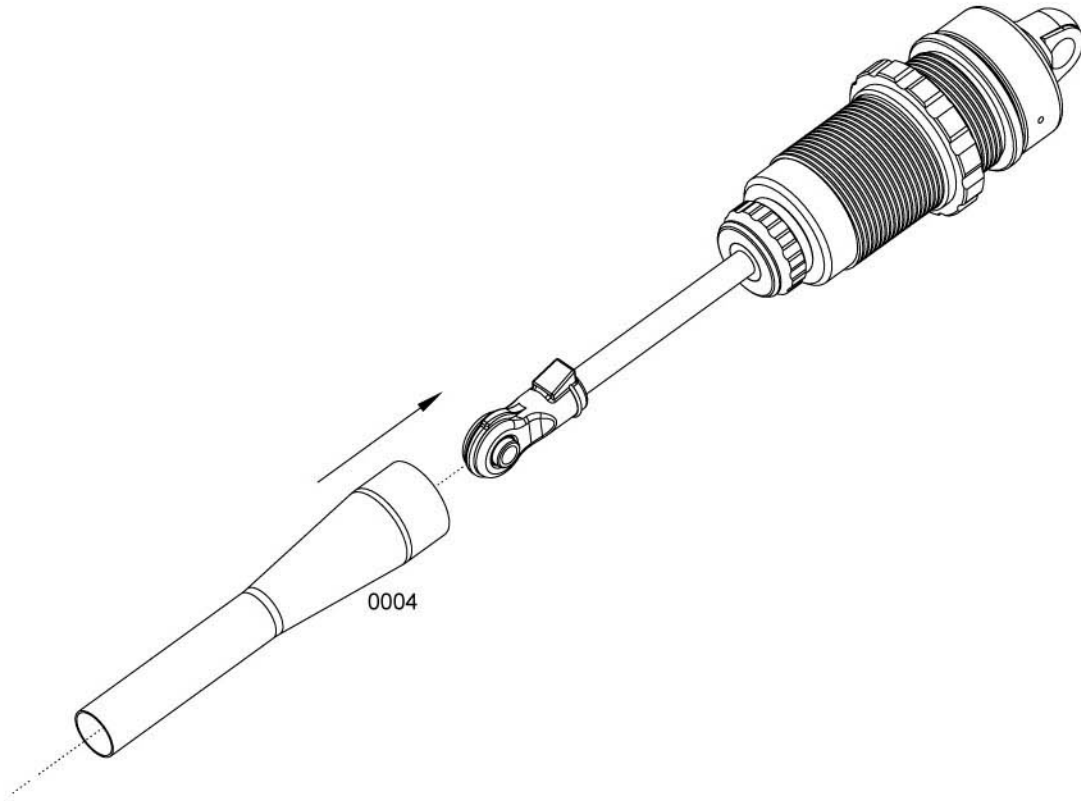

STEP B-5

Shock Install (Front & Rear)

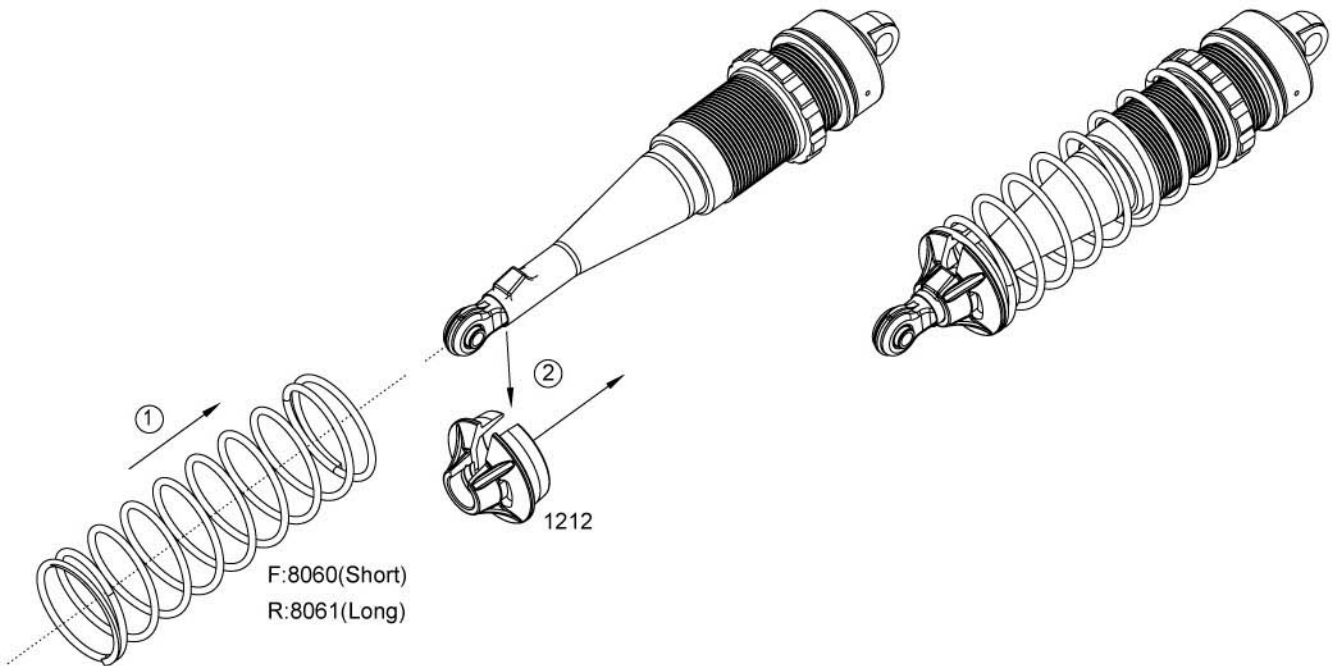

STEP C-1

Front Spindle & CV Installation

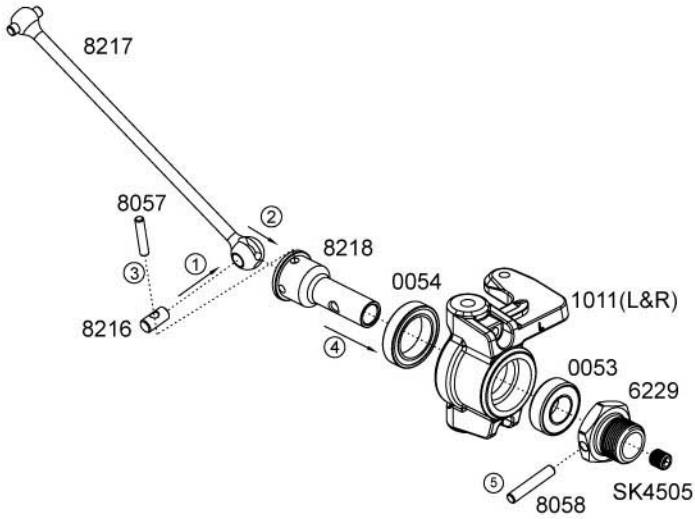

STEP C-2

Front Spindle & CV Installation

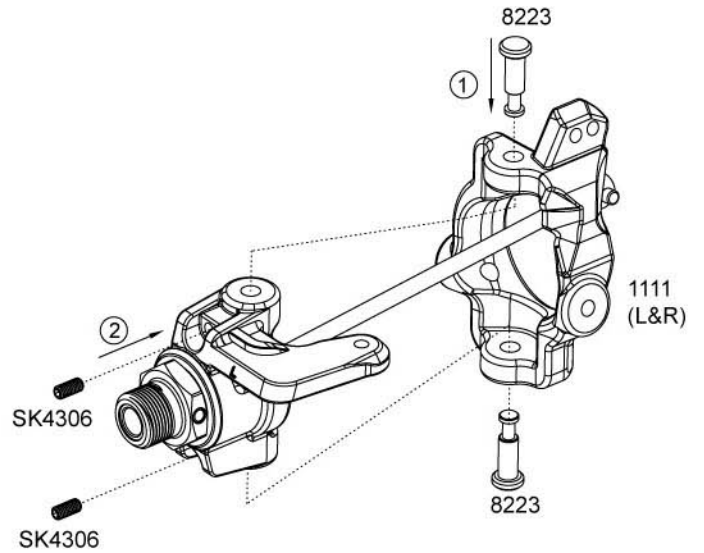

STEP C-3

Front Spindle & CV Installation

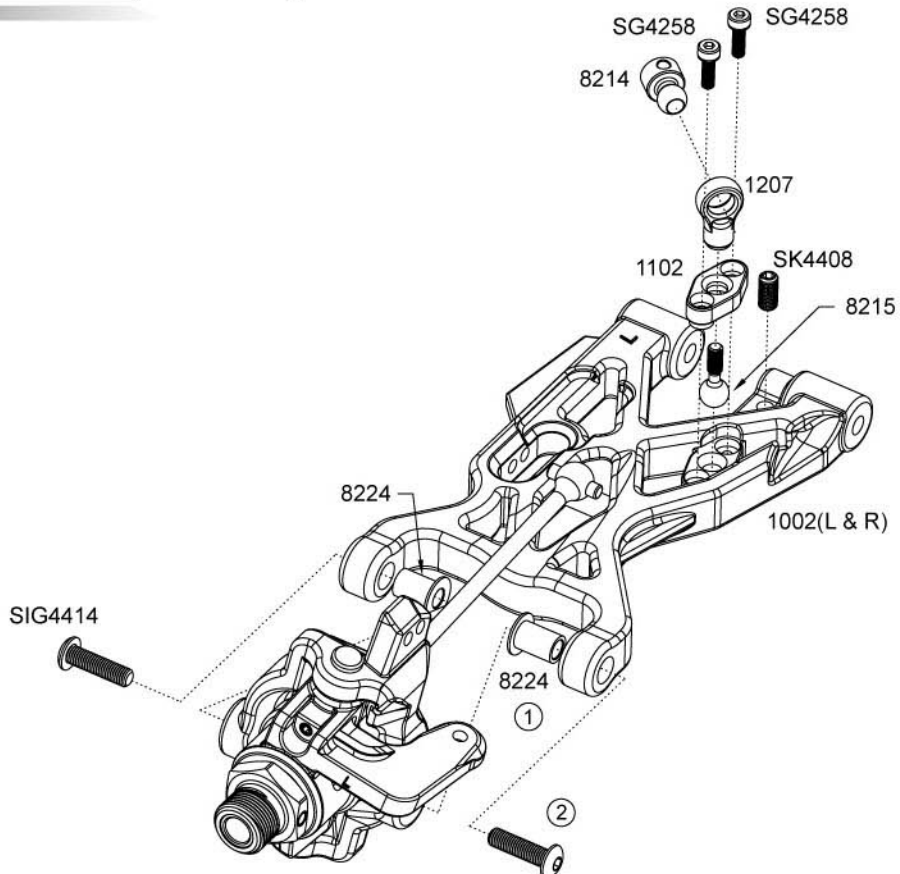

STEP D-1

Front End Installation

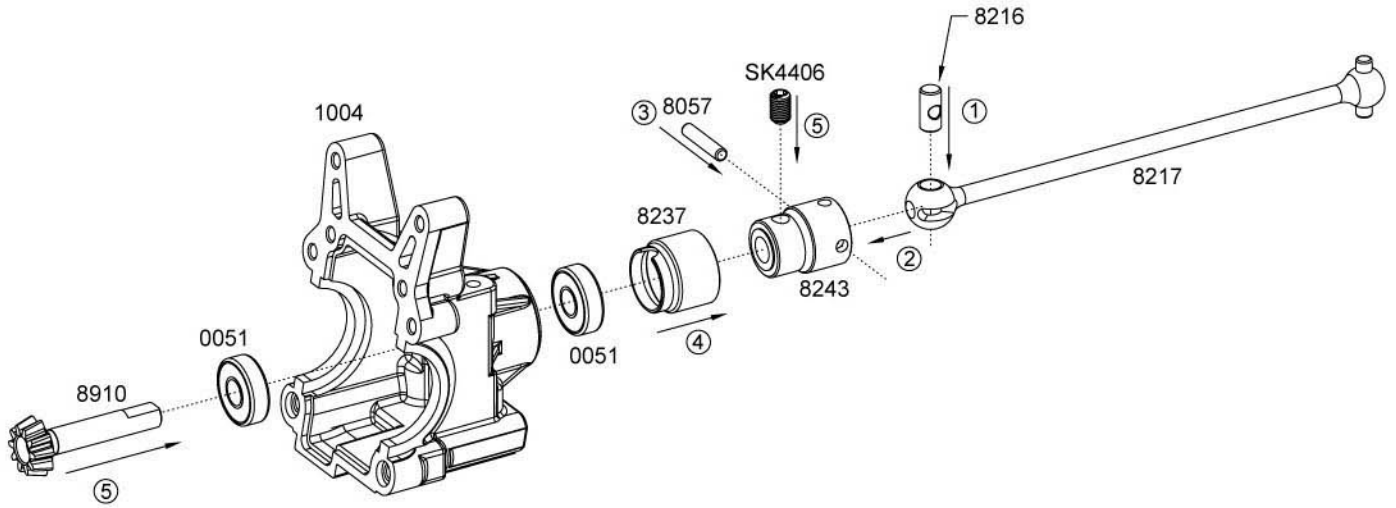

STEP D-2

Front End Installation

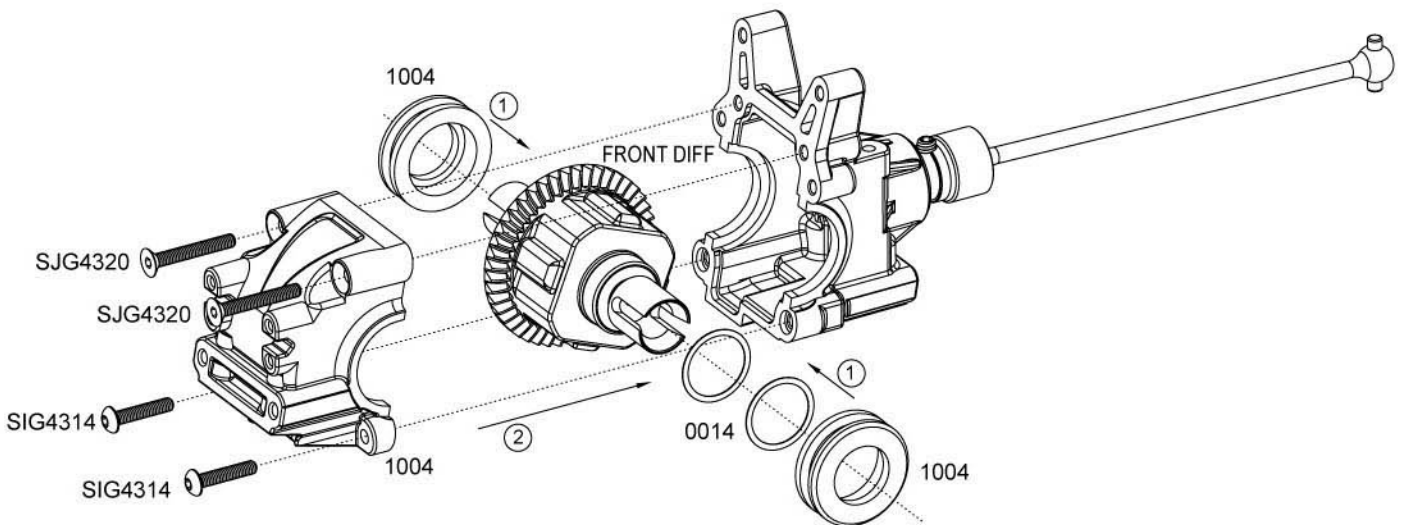

STEP D-3

Front End Installation

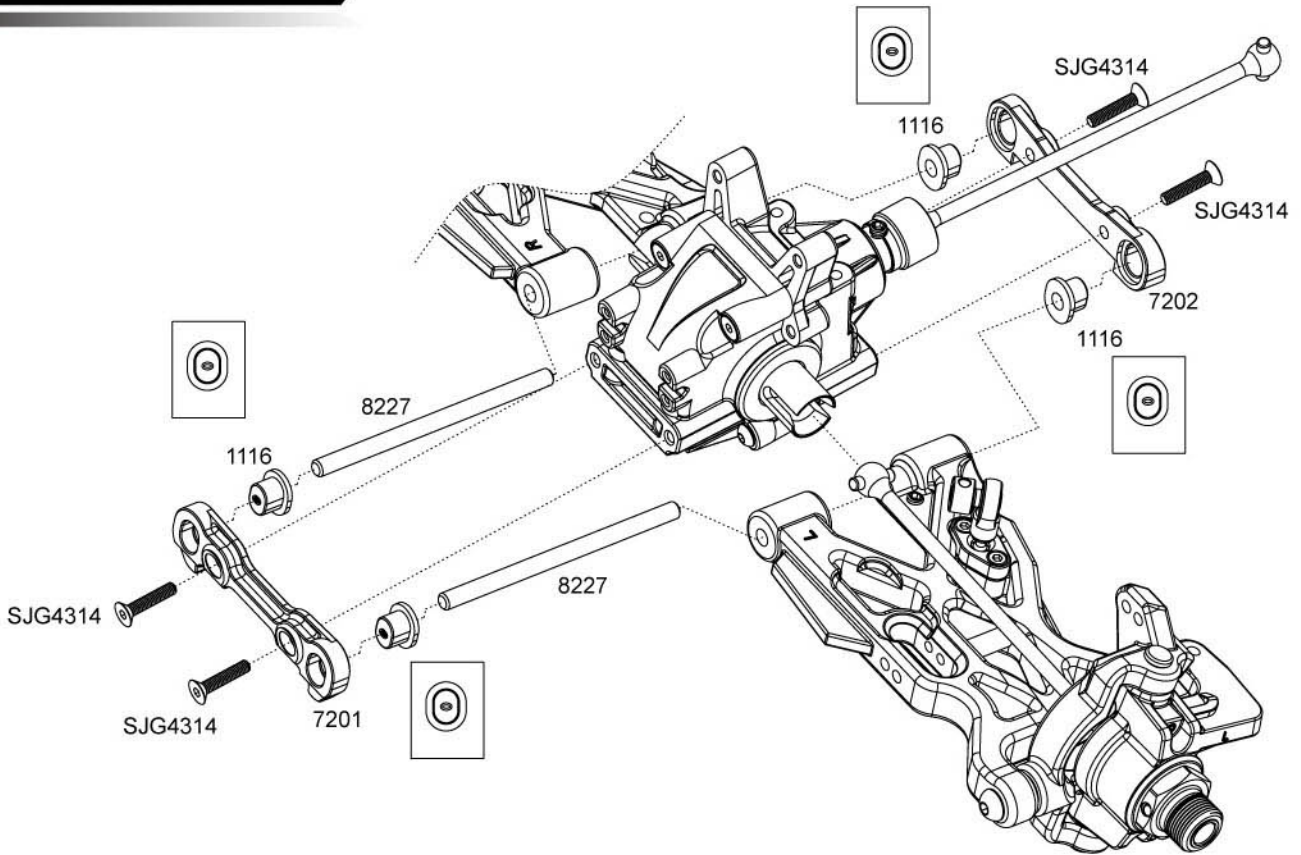

STEP D-4

Front End Installation

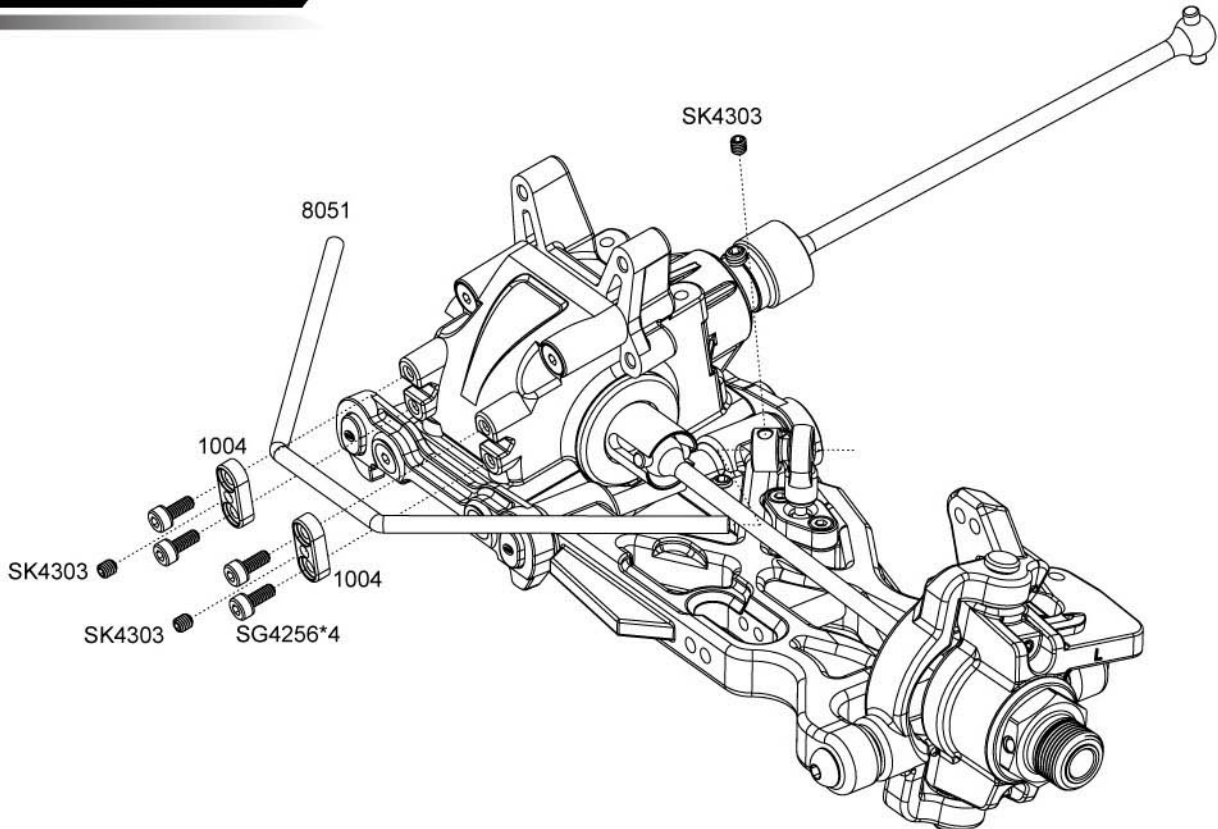

STEP D-5

Front End Installation

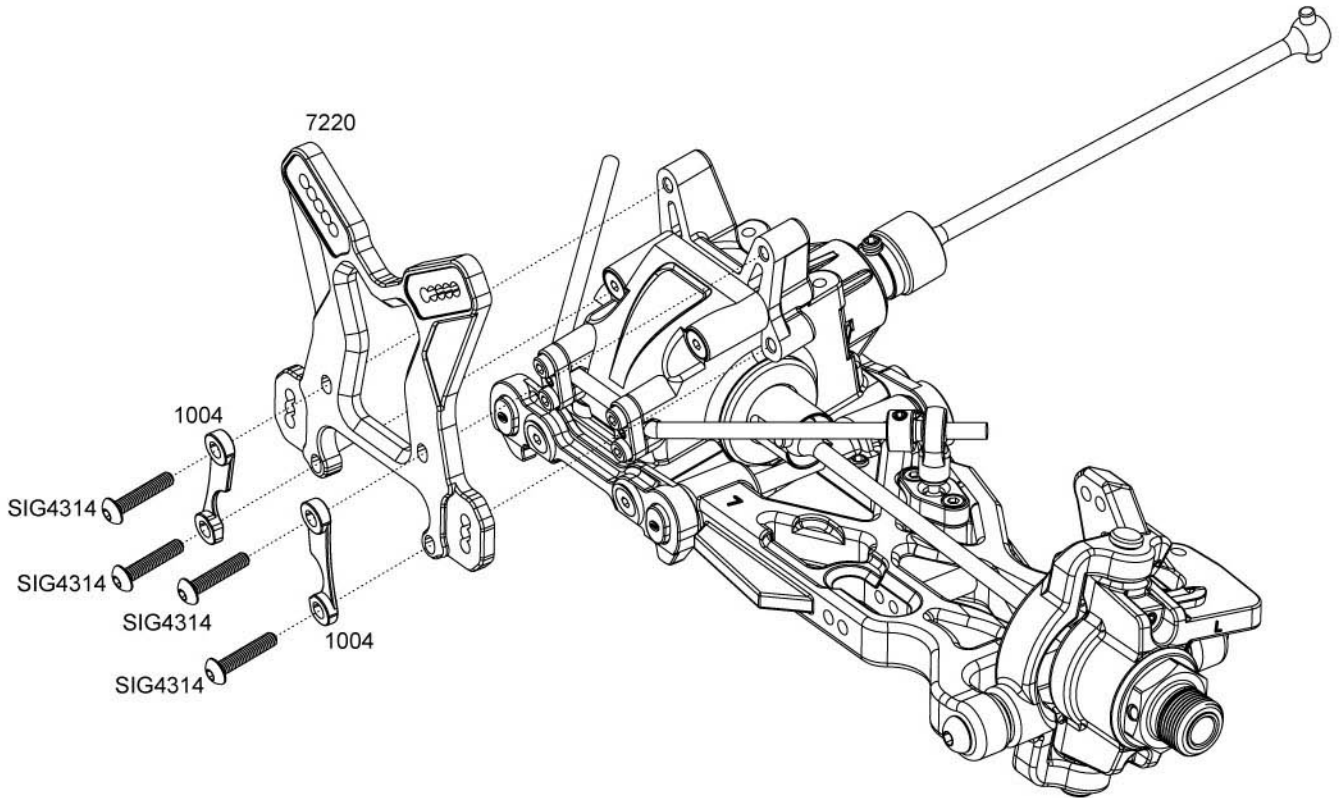

STEP D-6

Front End Installation

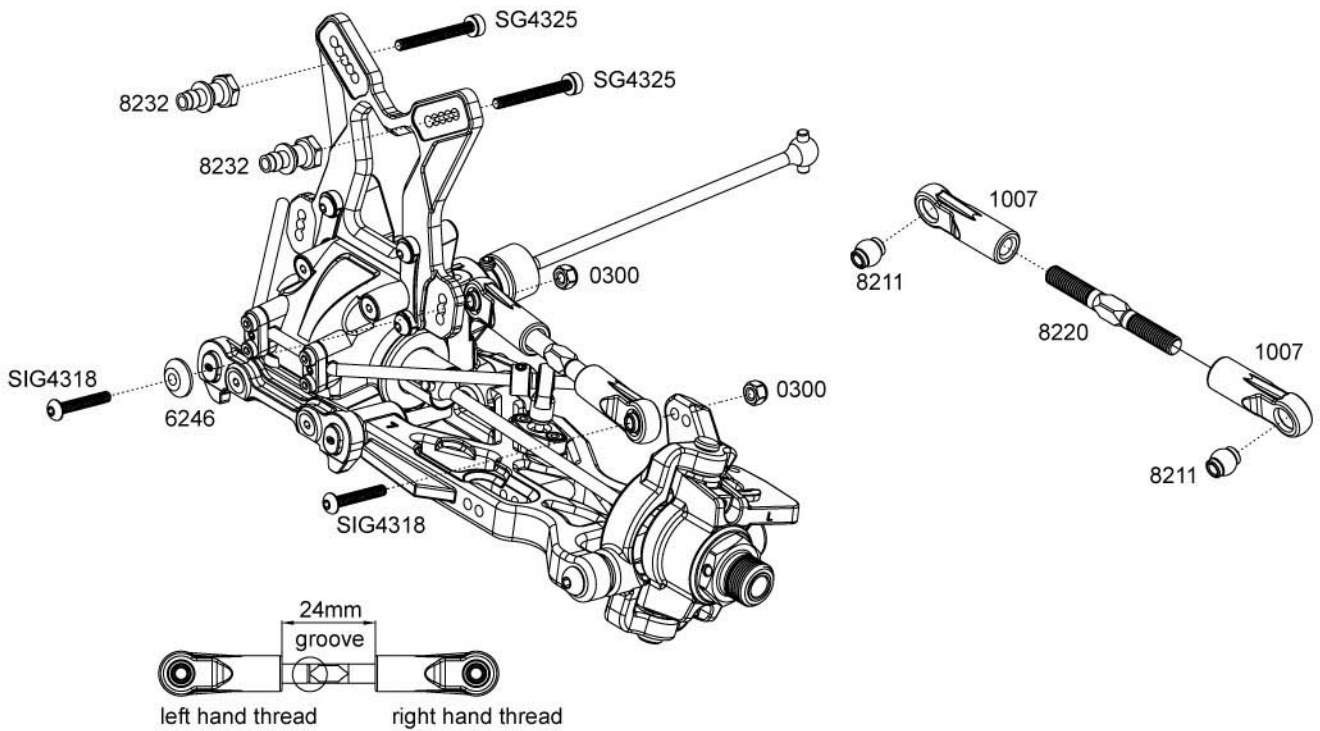

STEP D-7

Front End Installation

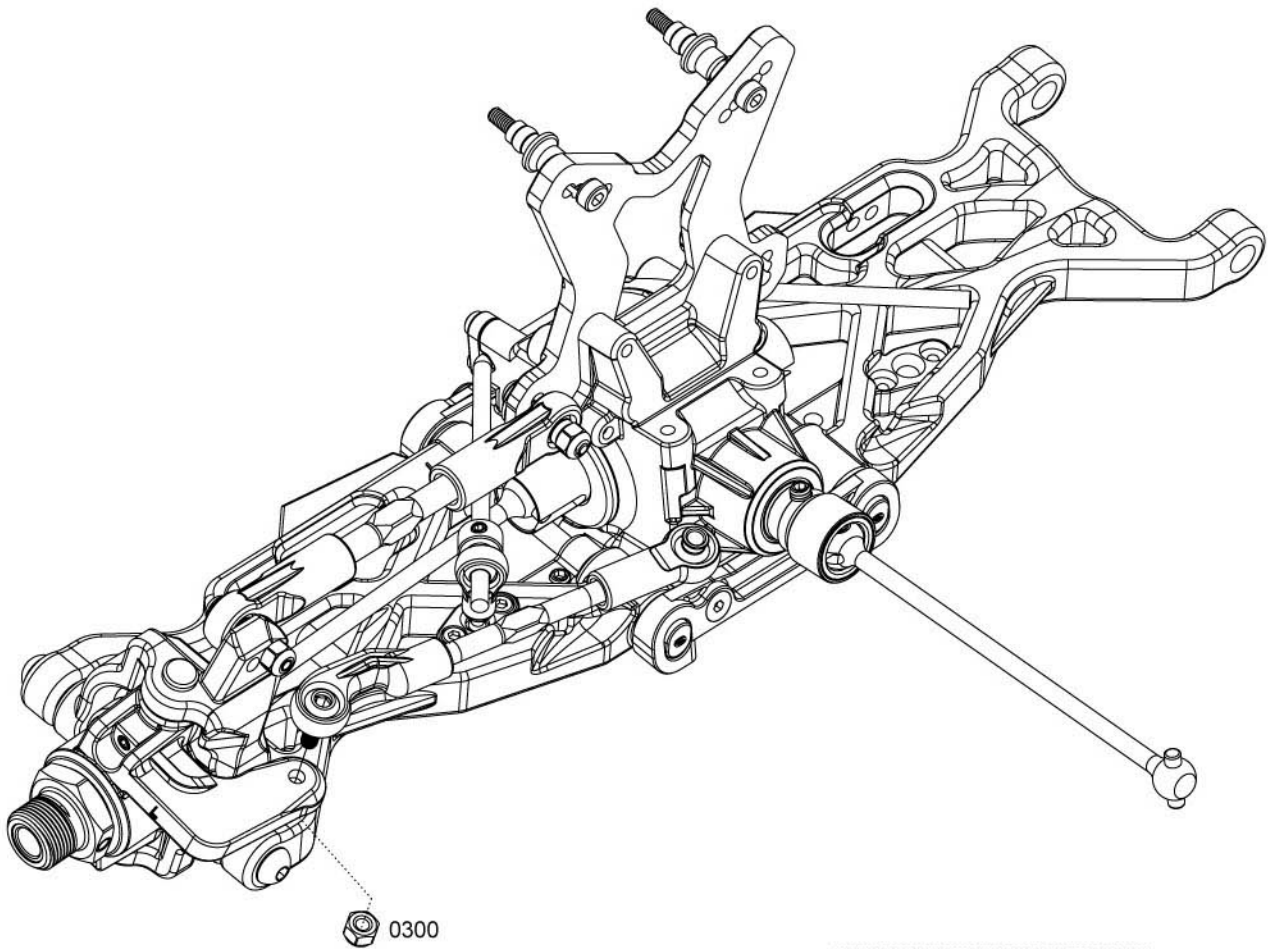

Bump Steer



Down

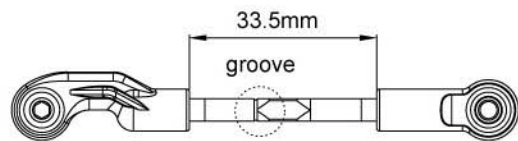
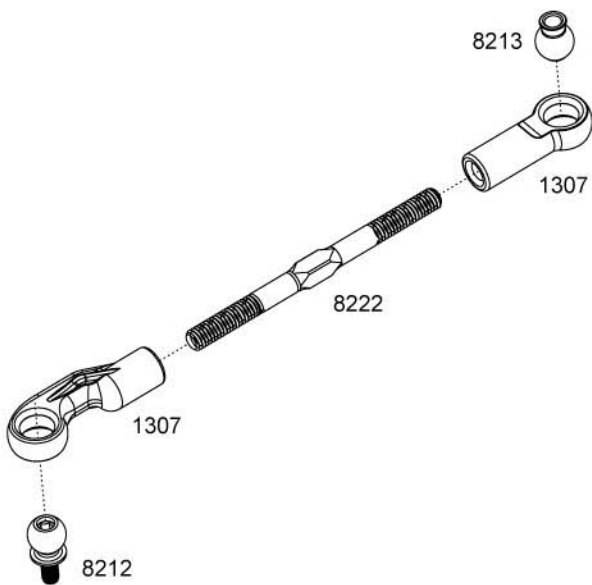

STEP E-1

Rear Hub & CV Installation

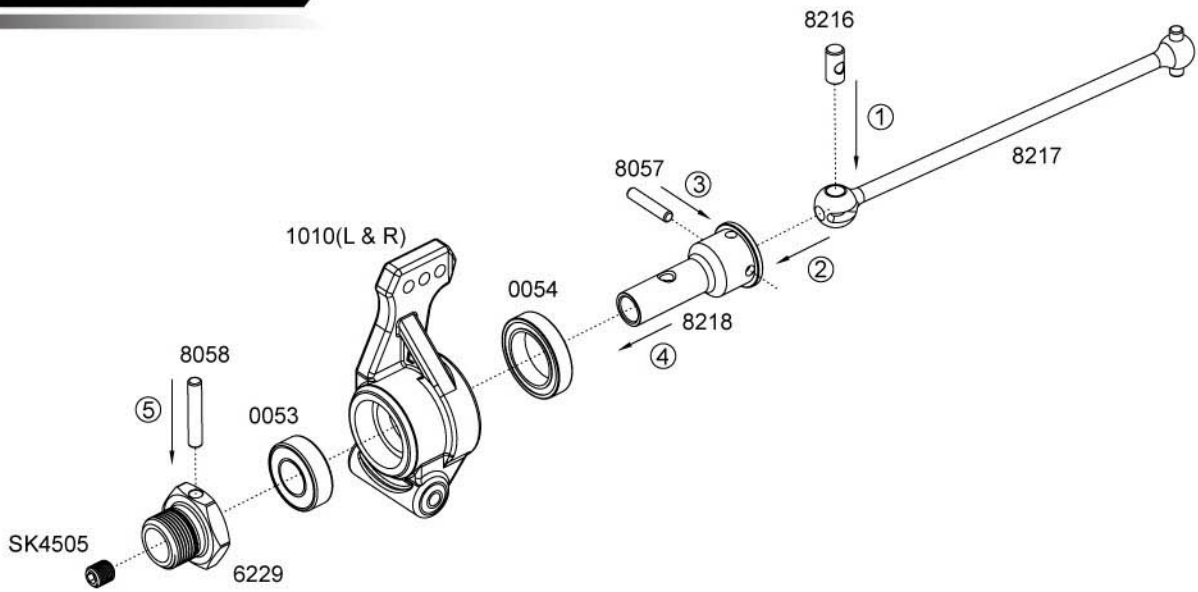

STEP E-2

Rear Hub & CV Installation

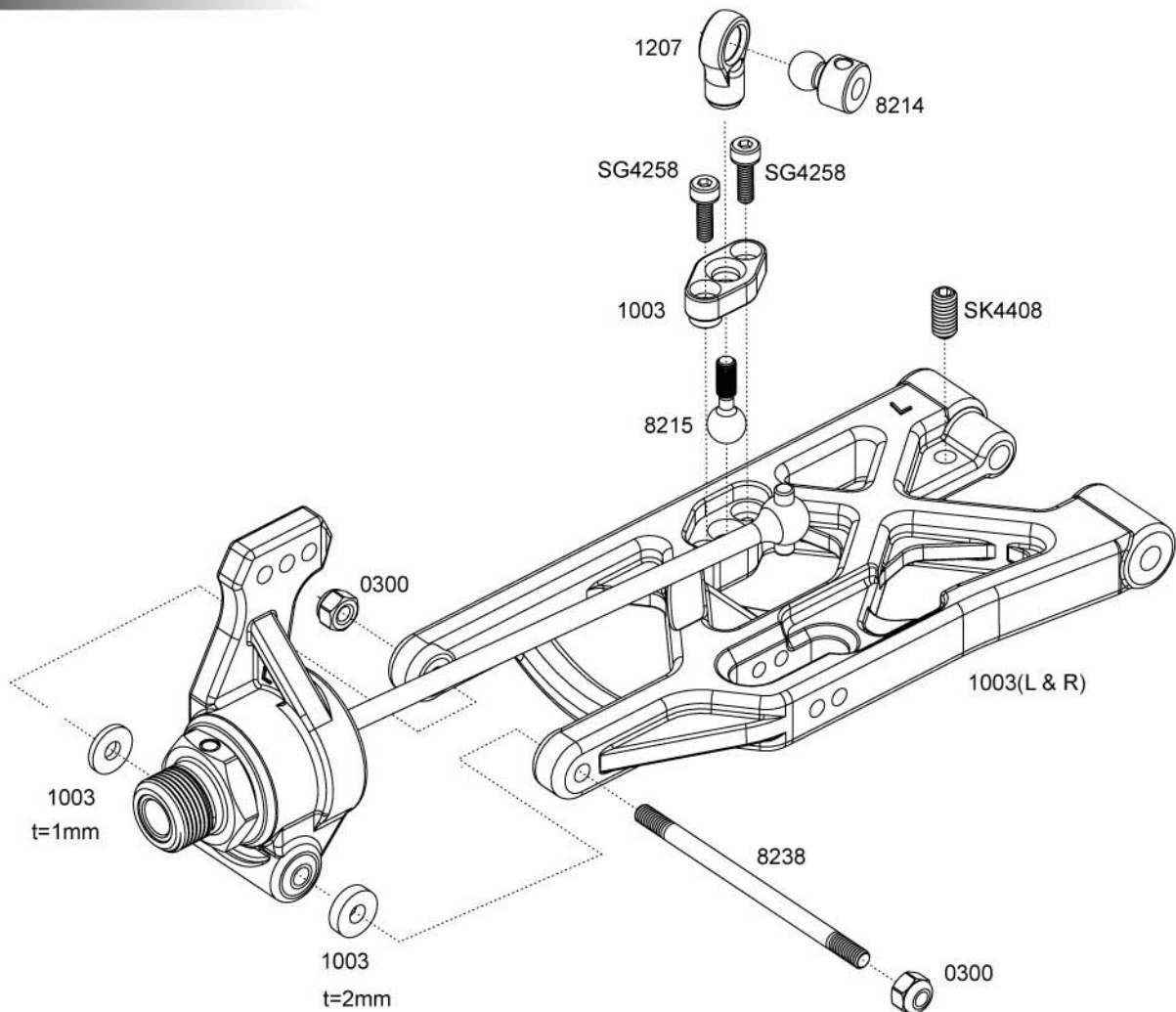

STEP F-1

Rear End Installation

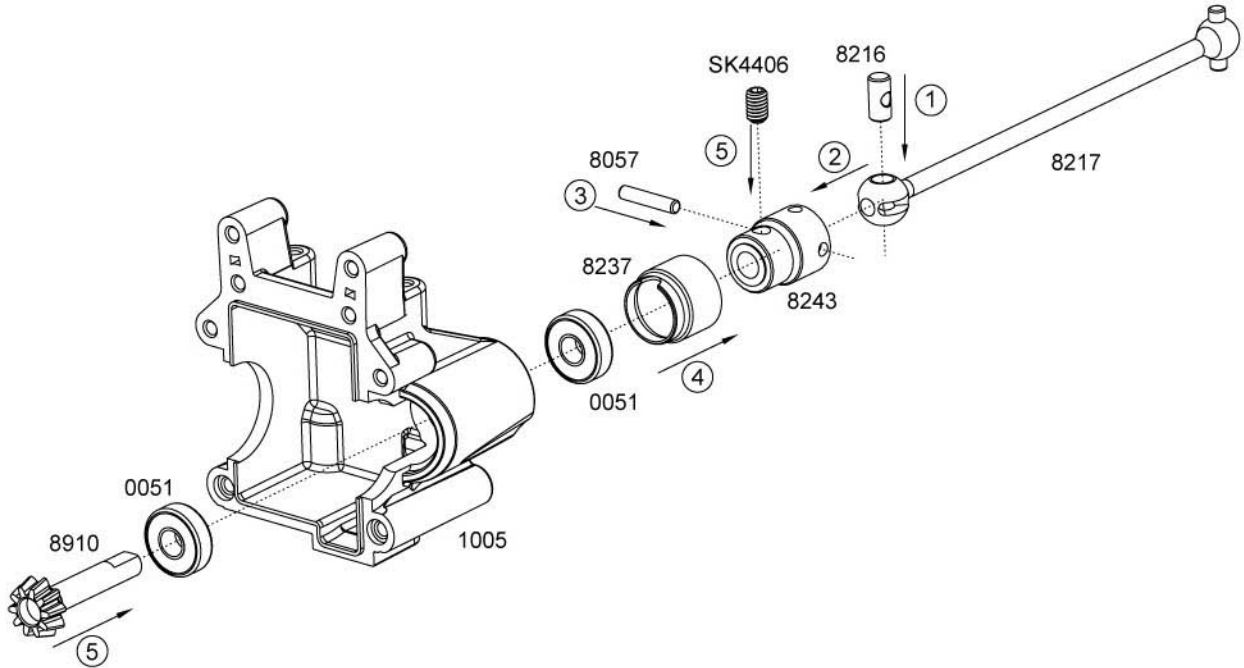

STEP F-2

Rear End Installation

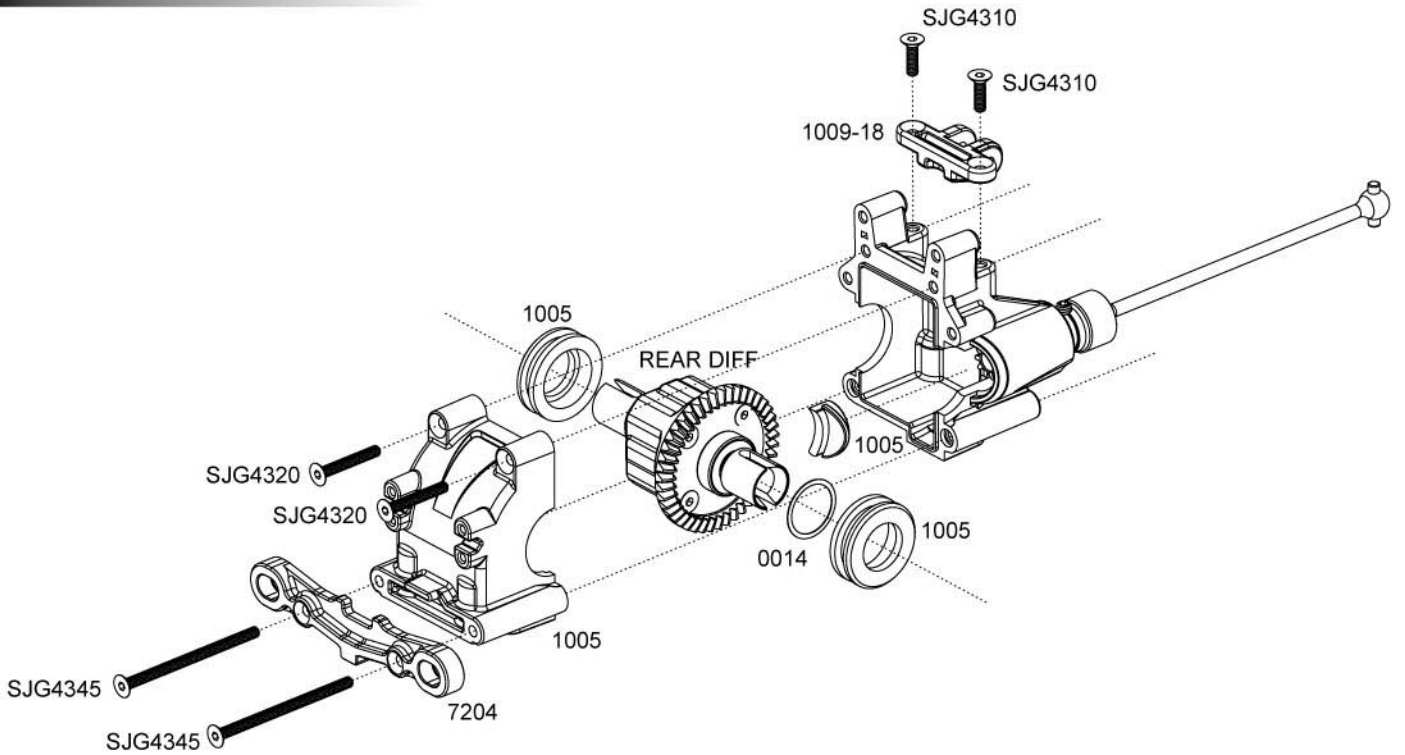

STEP F-3

Rear End Installation

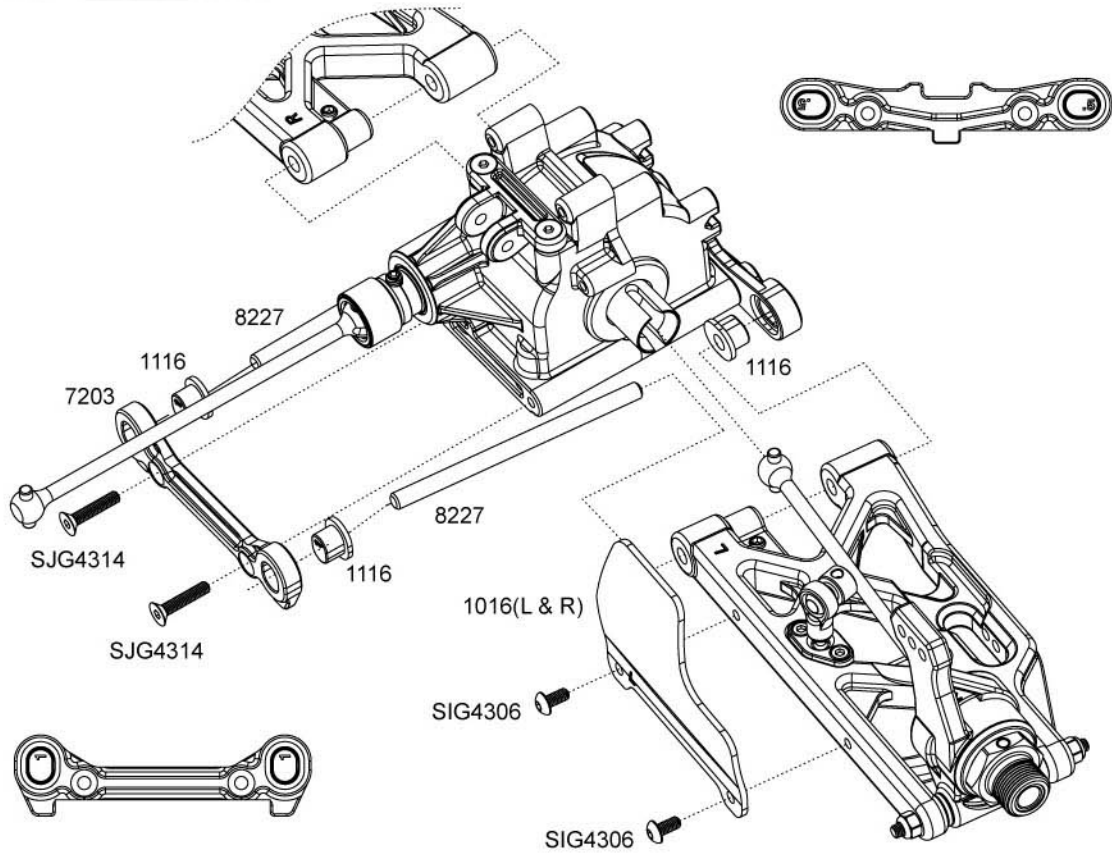

STEP F-4

Rear End Installation

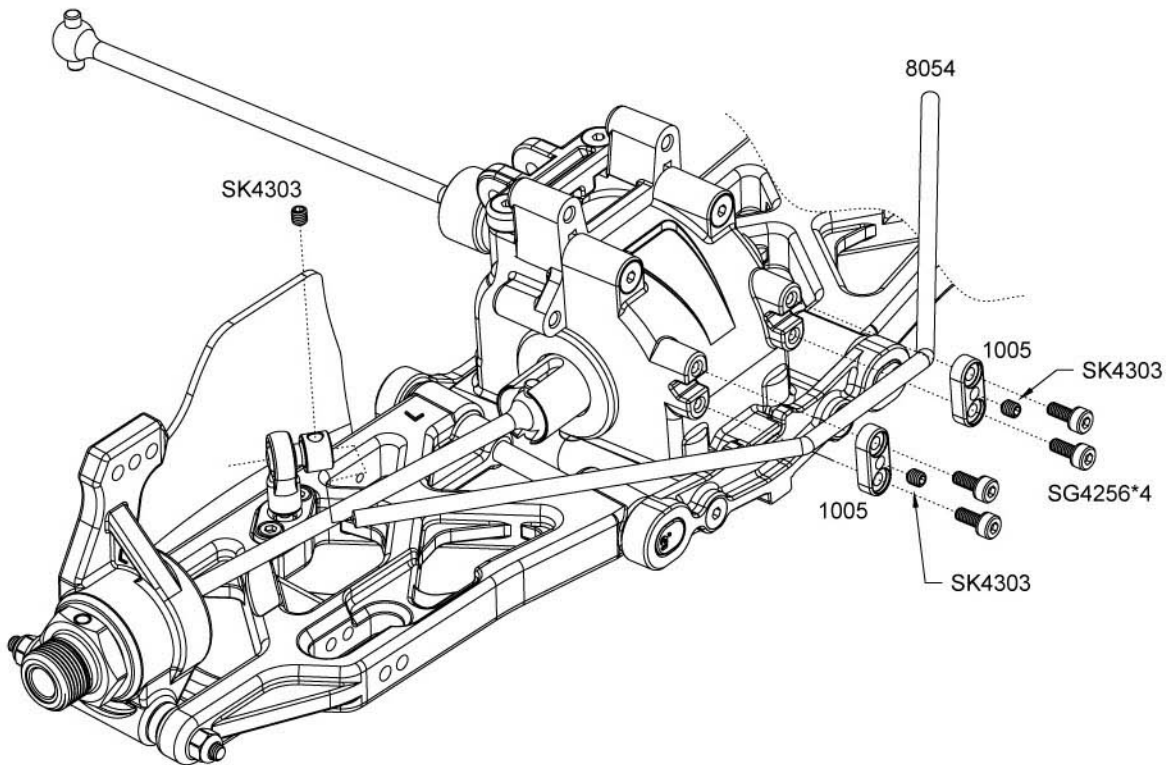

STEP F-5

Rear End Installation

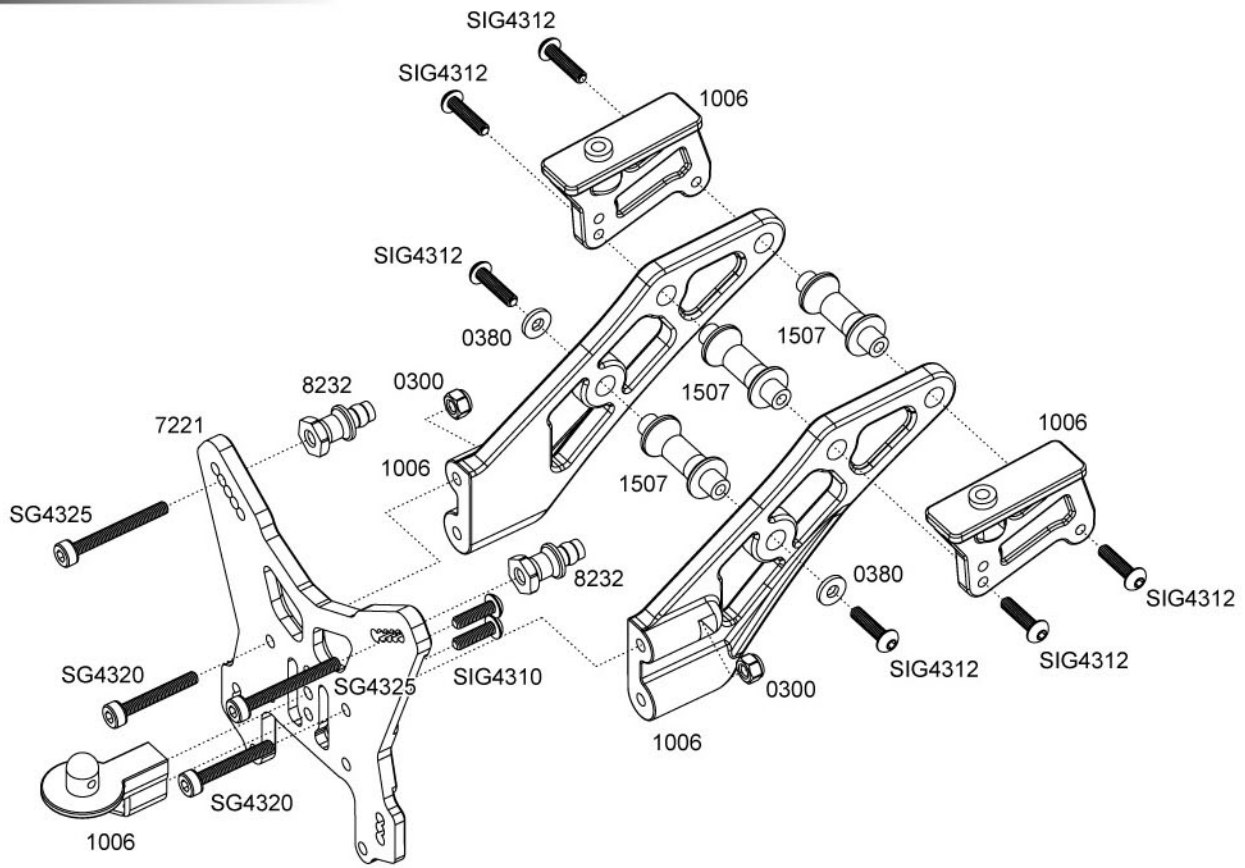

STEP F-6

Rear End Installation

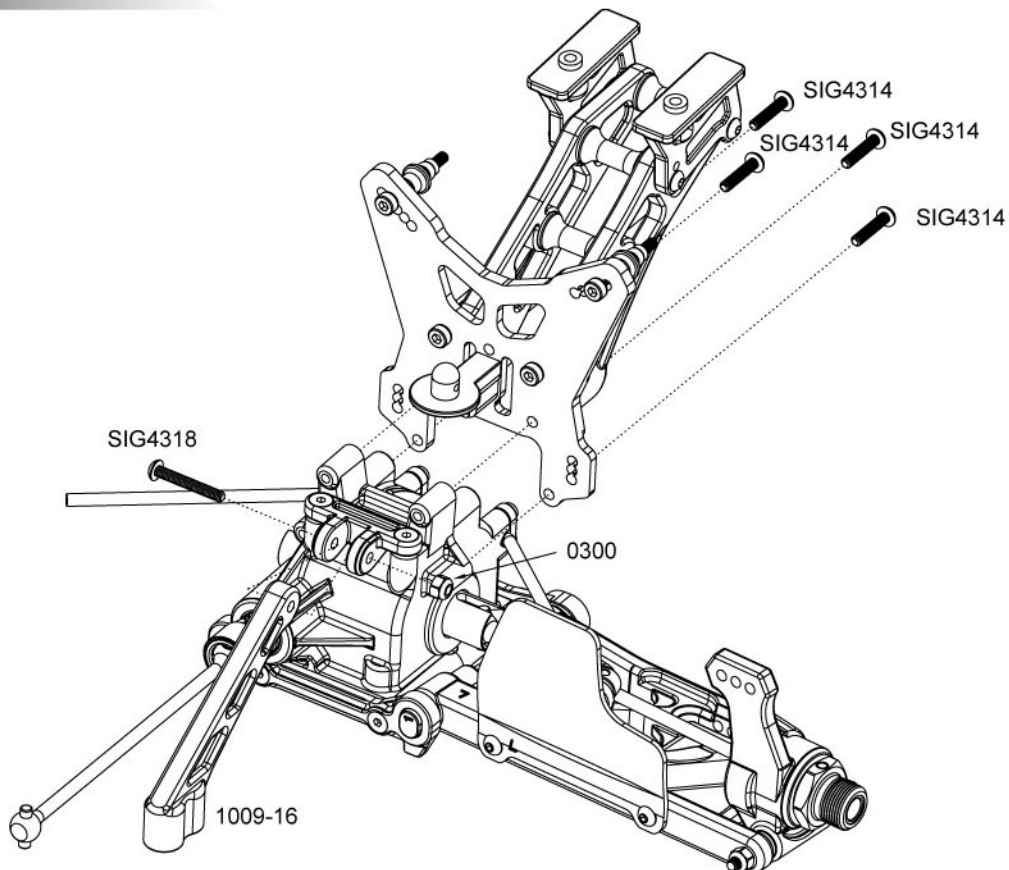

STEP F-7

Rear End Installation

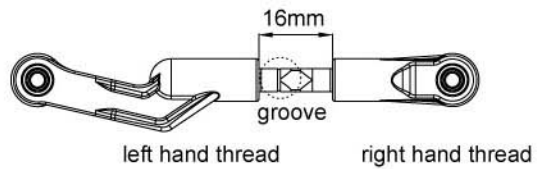
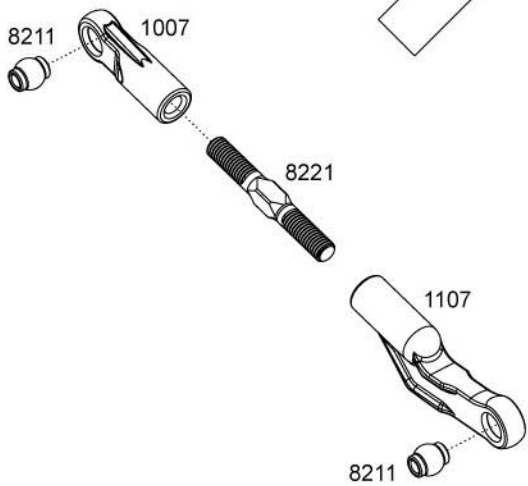
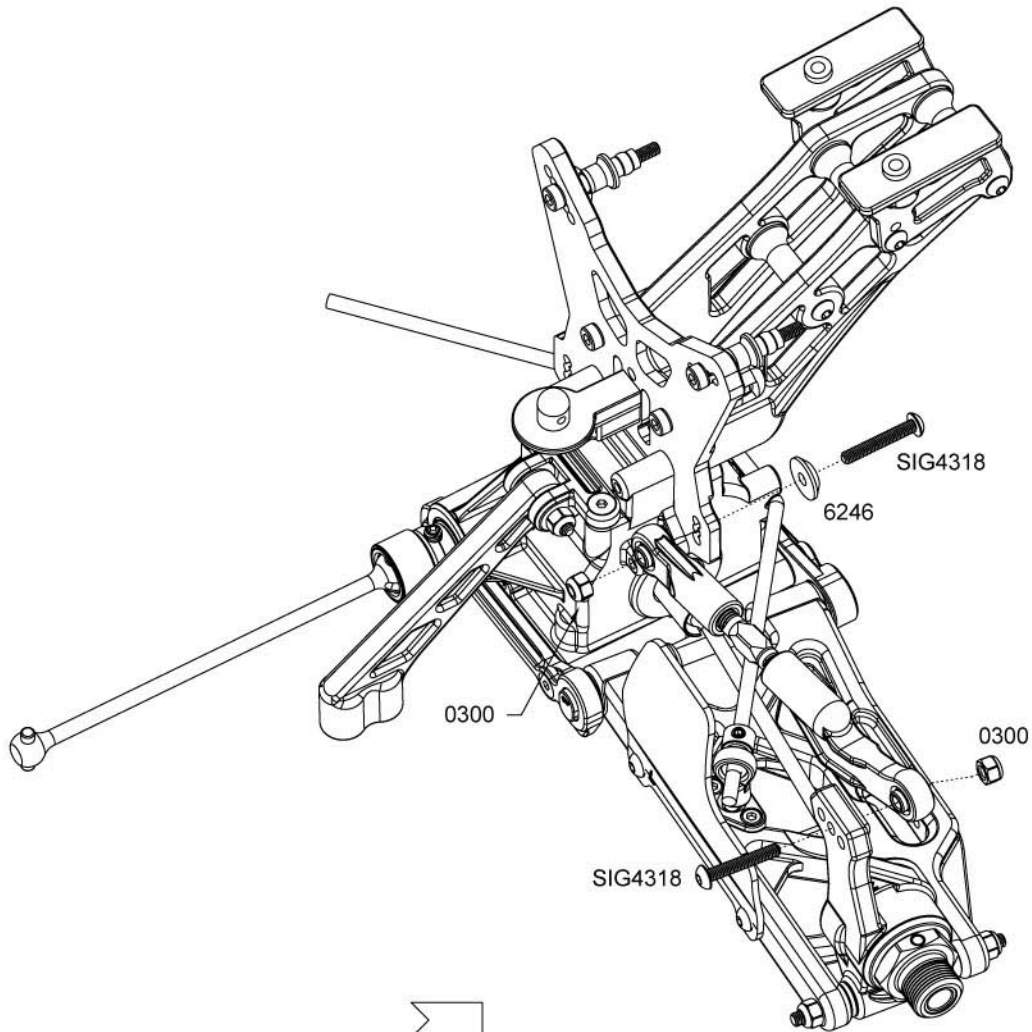

STEP G-1

Center Diff/Brake Installation

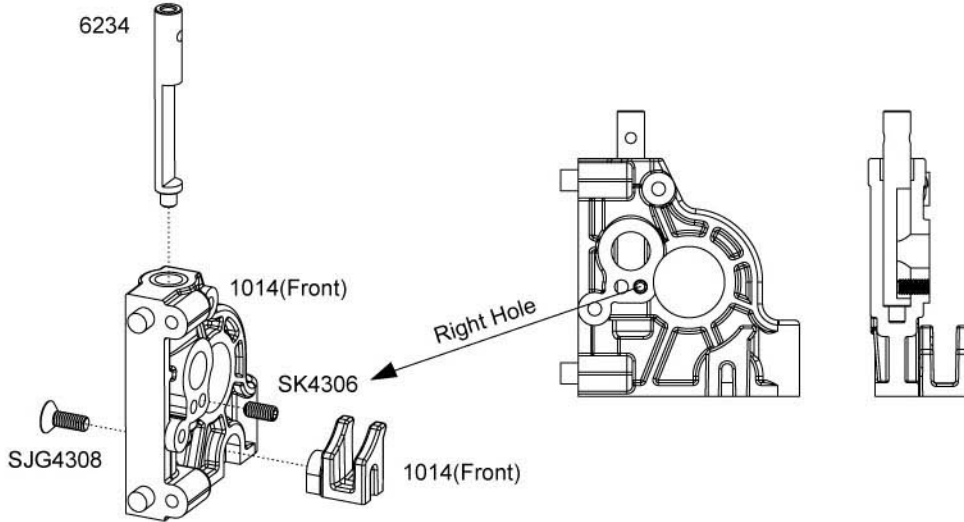

STEP G-2

Center Diff/Brake Installation

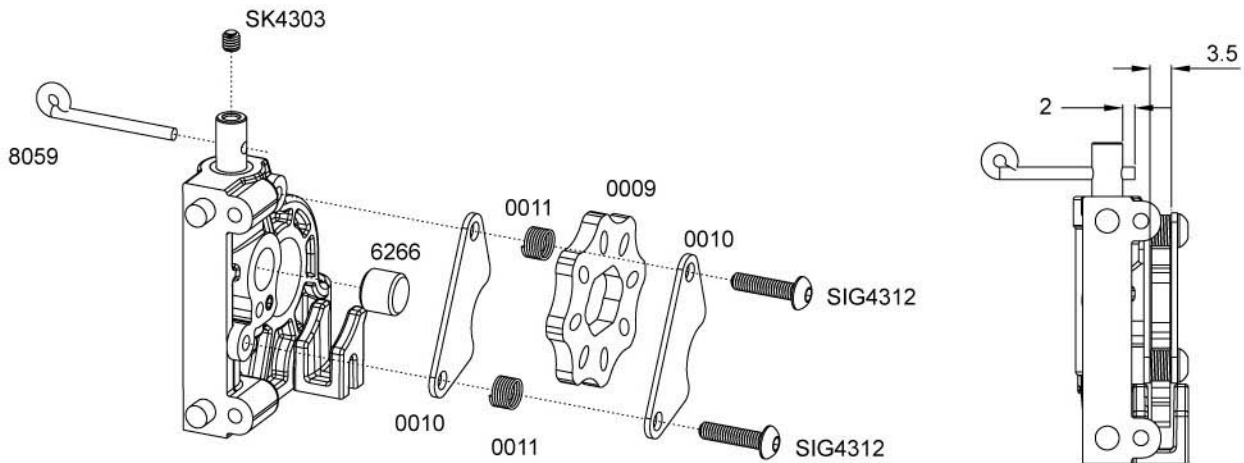

STEP G-3

Center Diff/Brake Installation

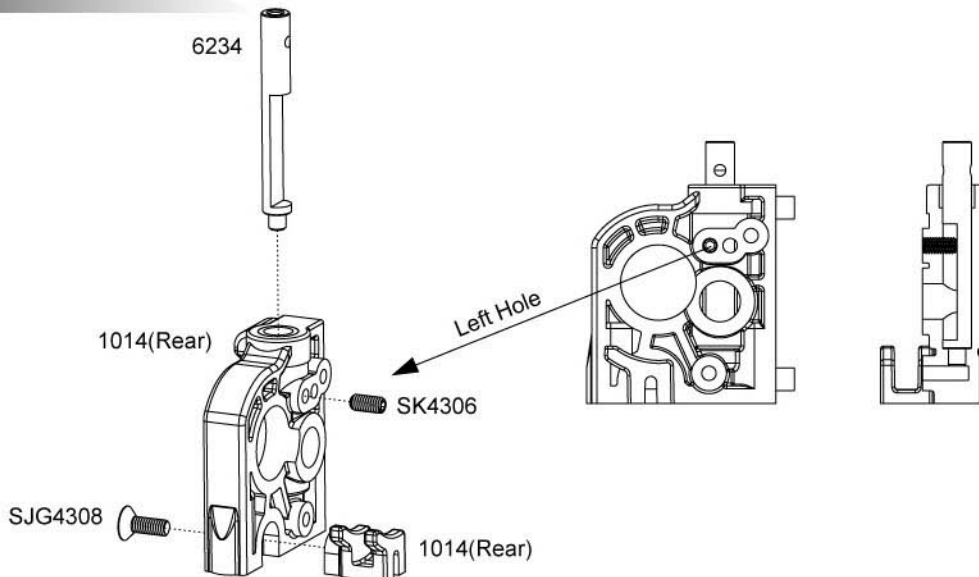

STEP G-4

Center Diff/Brake Installation

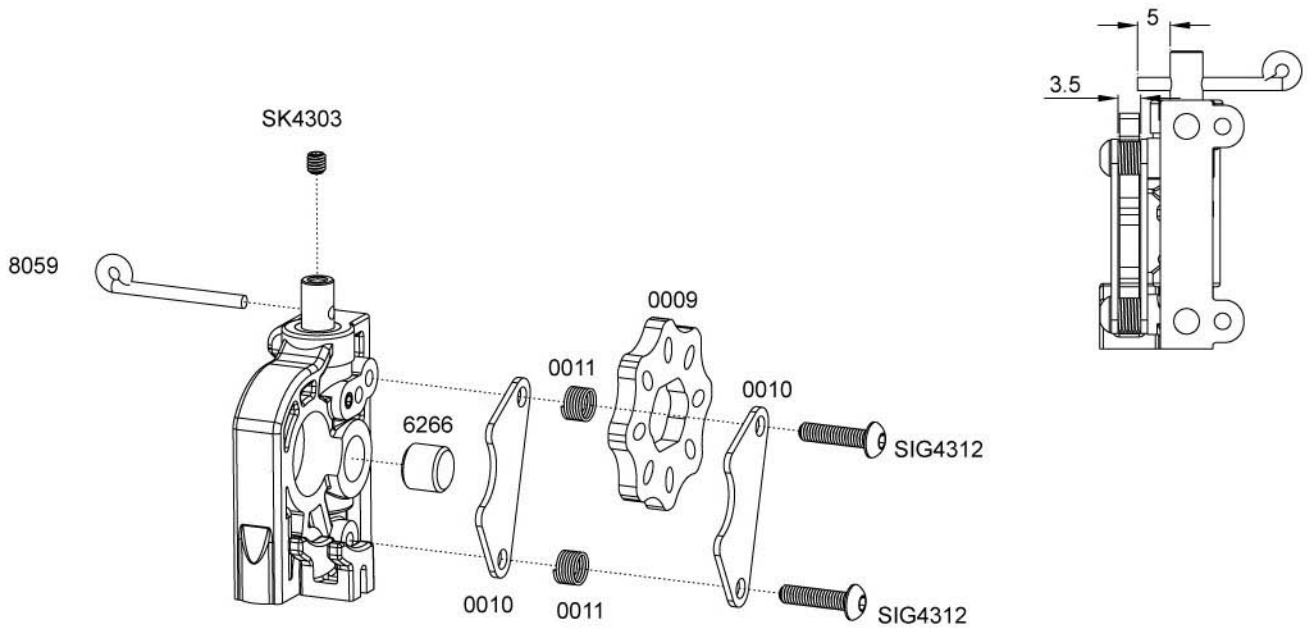

STEP G-5

Center Diff/Brake Installation

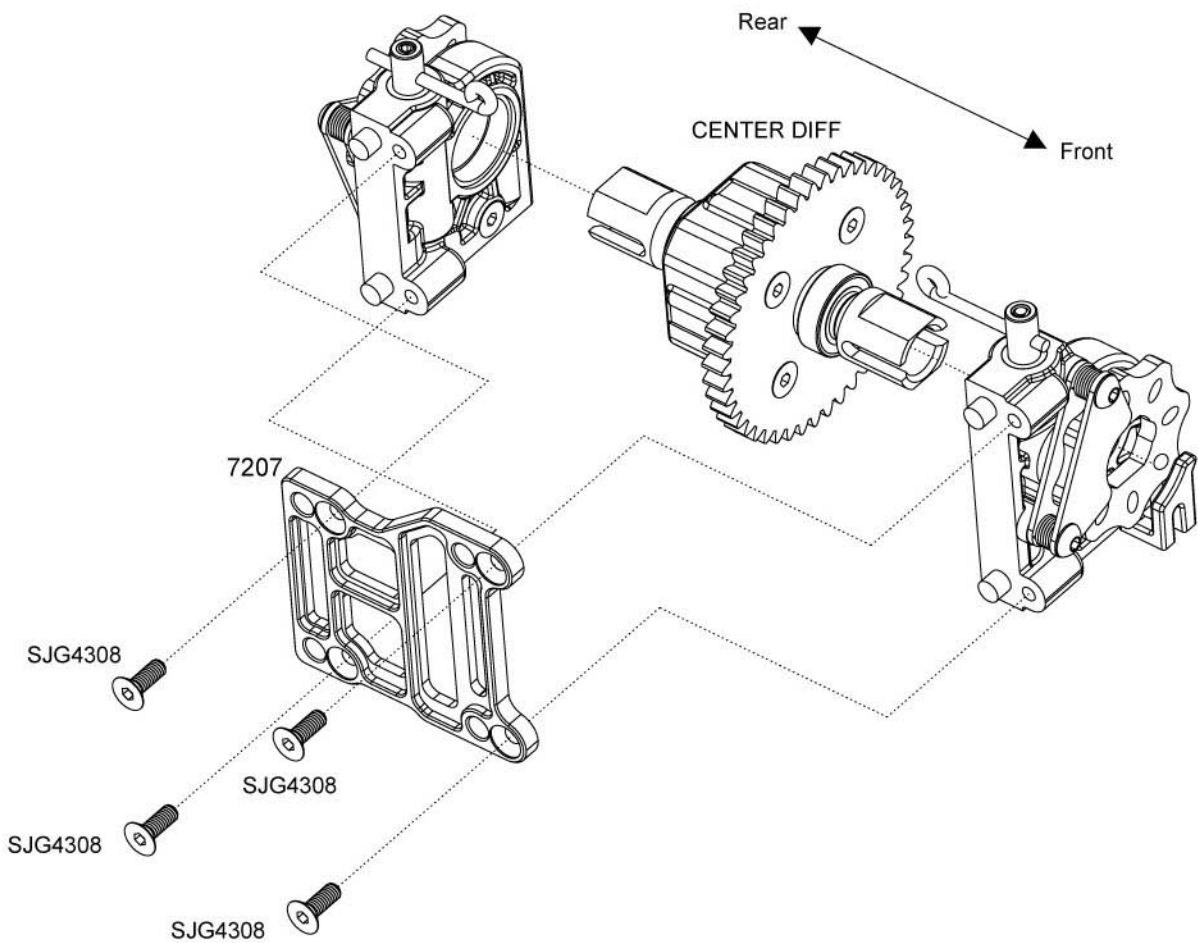

STEP H-1

Switch/Antenna tube Installation

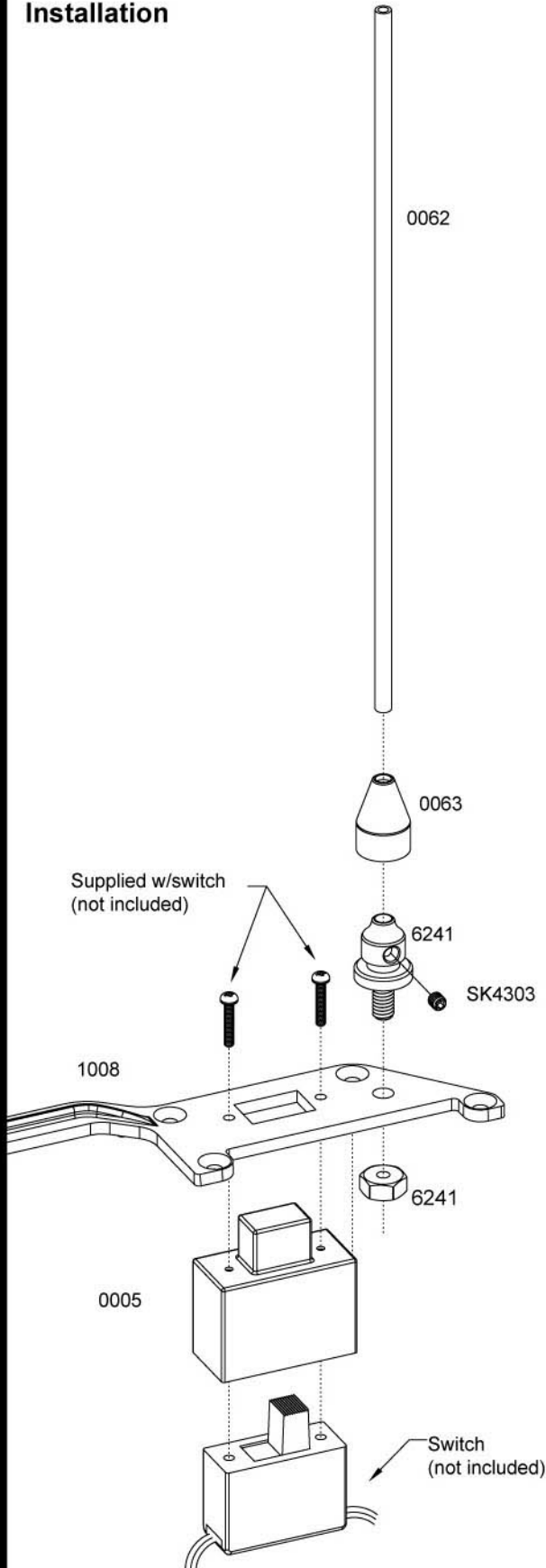

STEP H-2

Throttle Servo Installation (Servo forward)

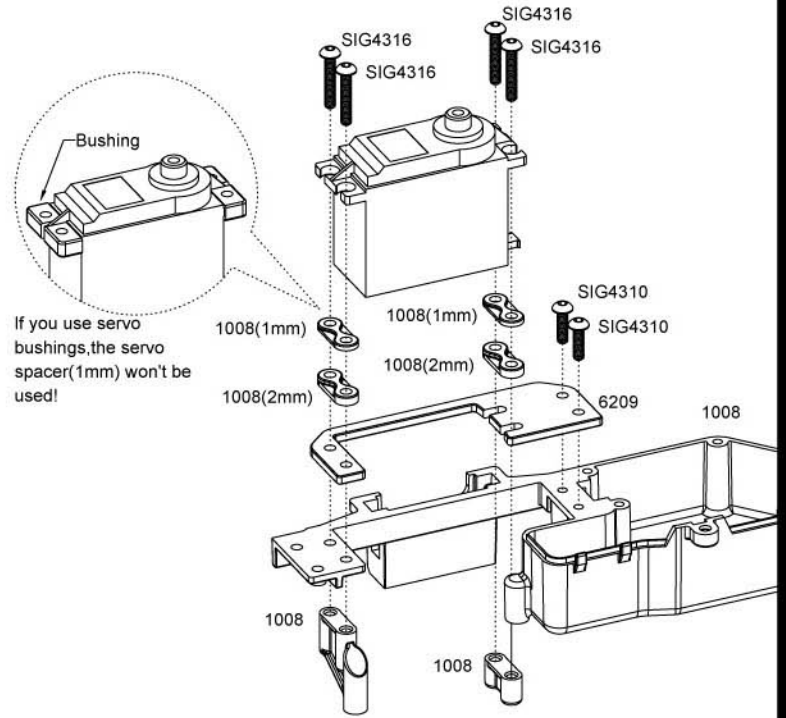

STEP H-3

Throttle Servo Installation (Servo backward)

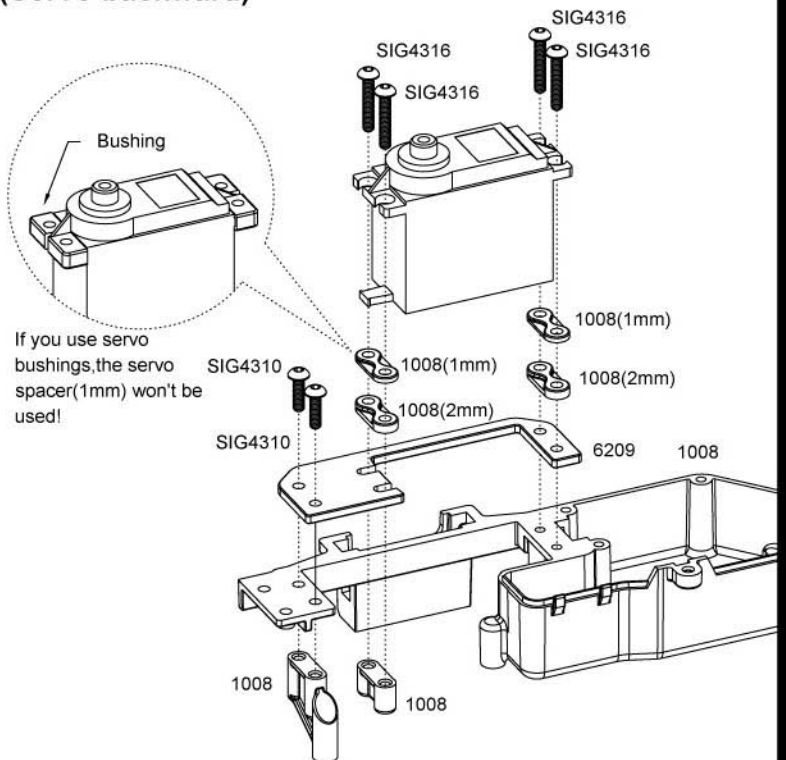

STEP H-4

Front End Installation

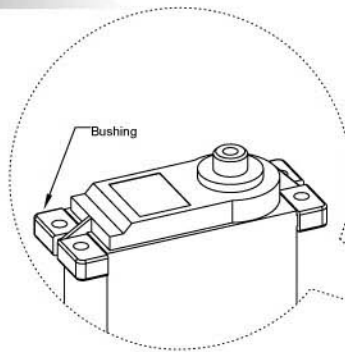

If you use servo bushings, the servo spacer(1mm) won't be used!

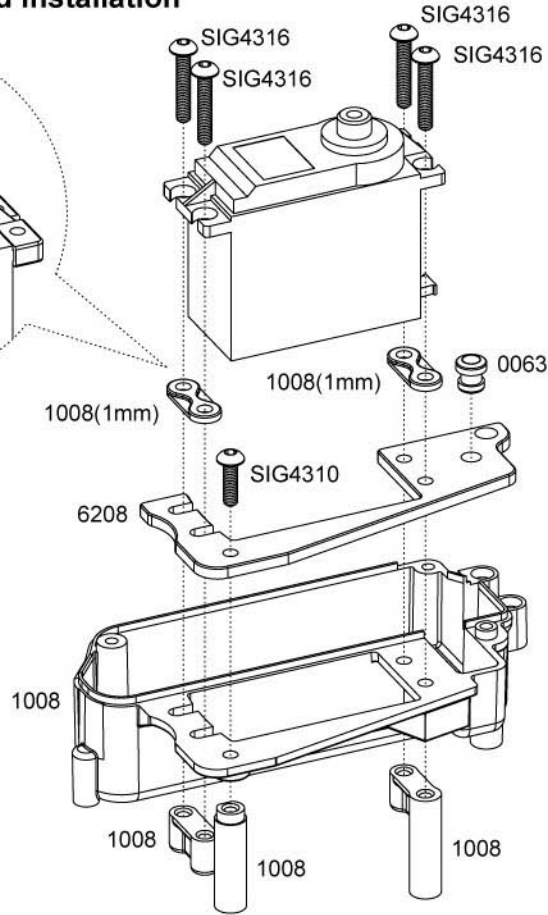

STEP H-5

Front End Installation

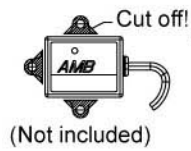
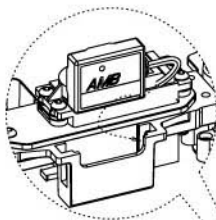

Battery

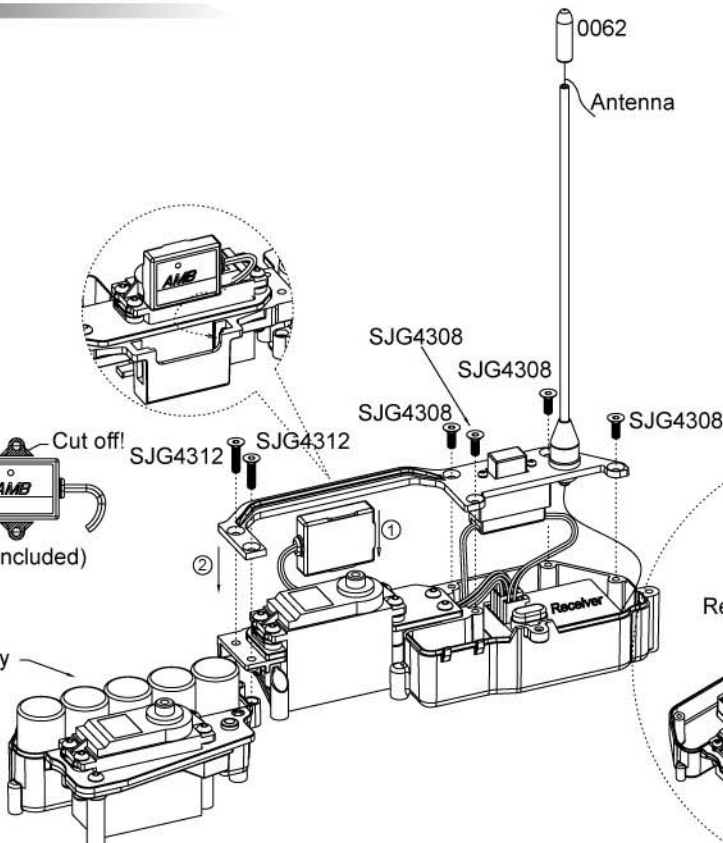

* You can adjust weight distribution by changing the battery's position

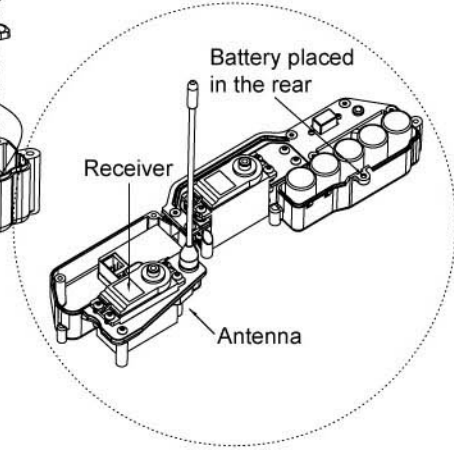

STEP H-6

Receiver/Battery Cover

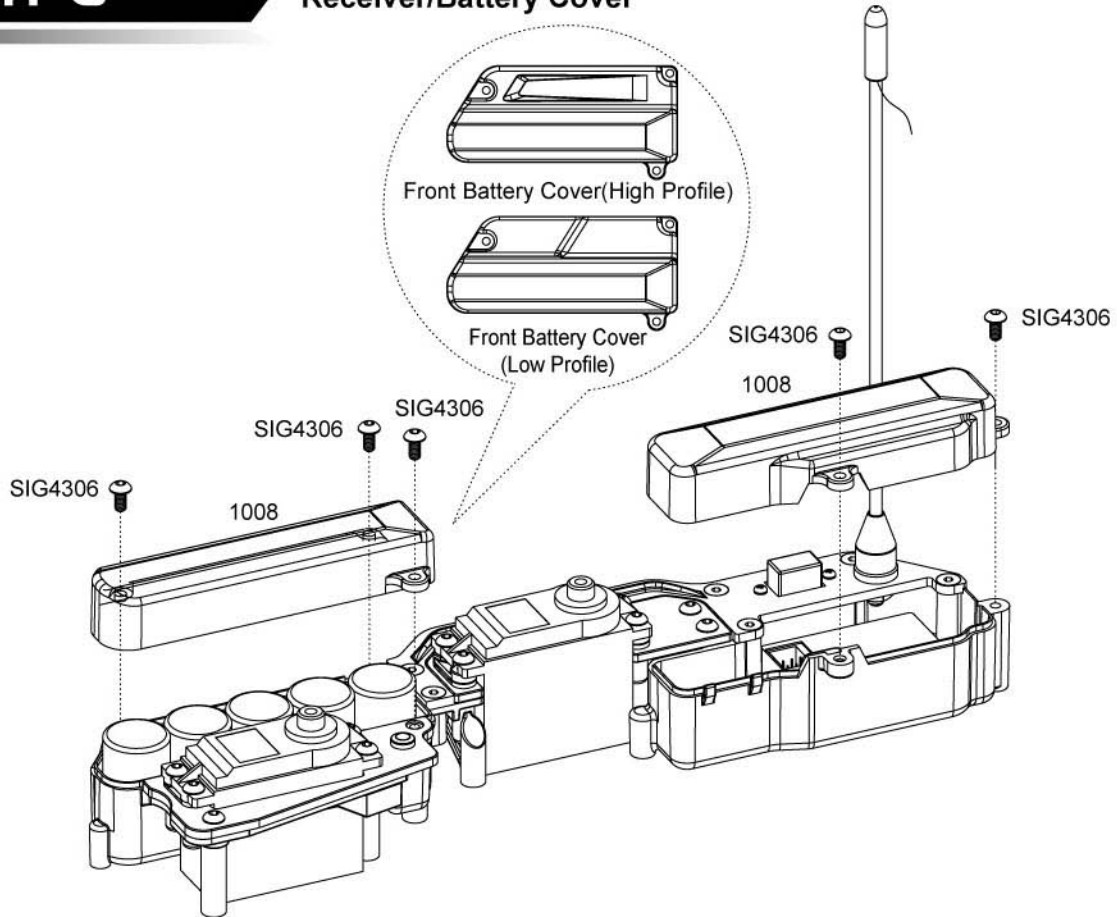

STEP H-7

Servo Horn Insert

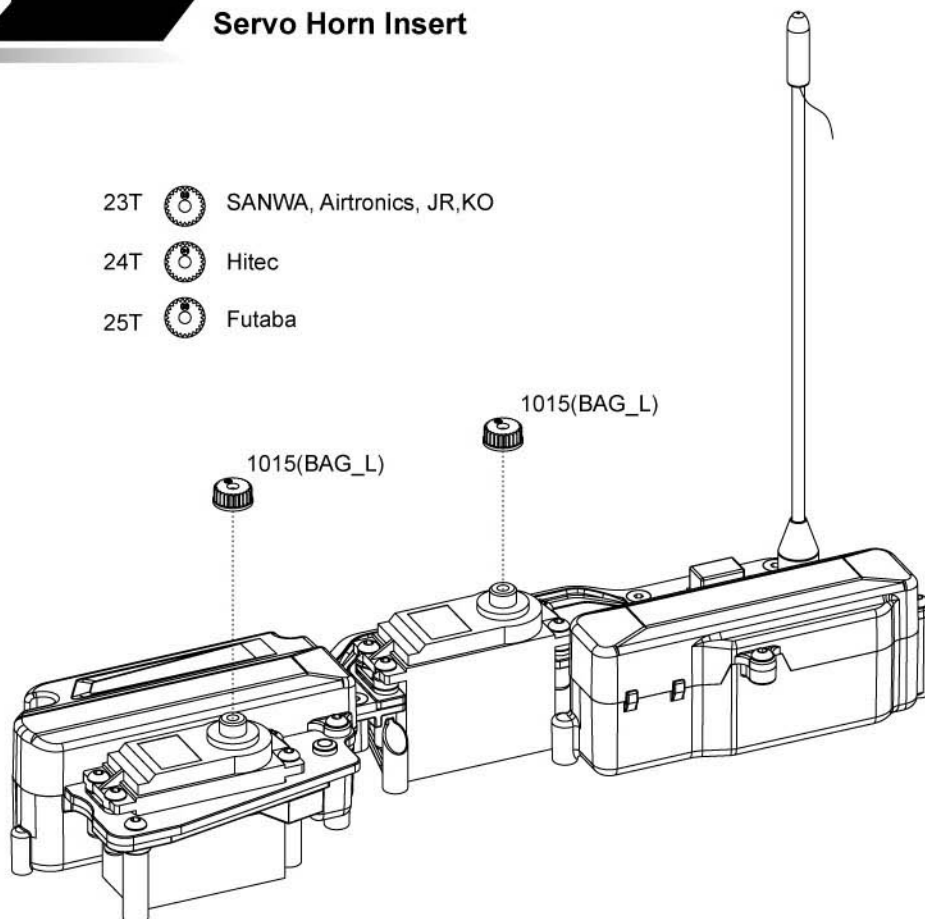

STEP H-8

Completed Radio Tray Assembly

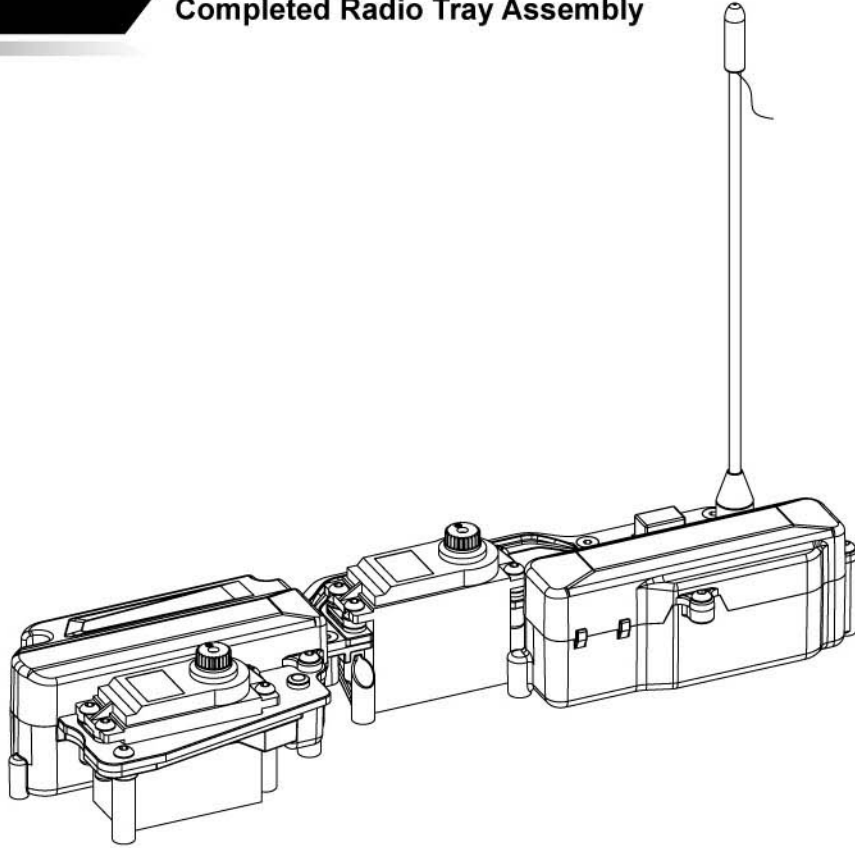

BAG I

STEP I-1

Clutch Assembly

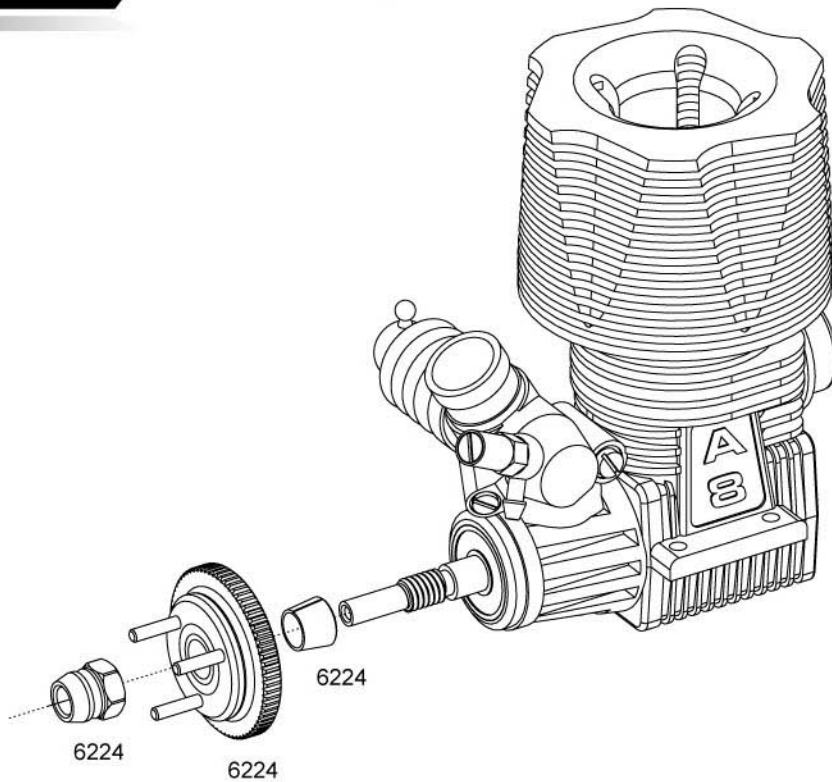

STEP 1-2

Clutch Assembly

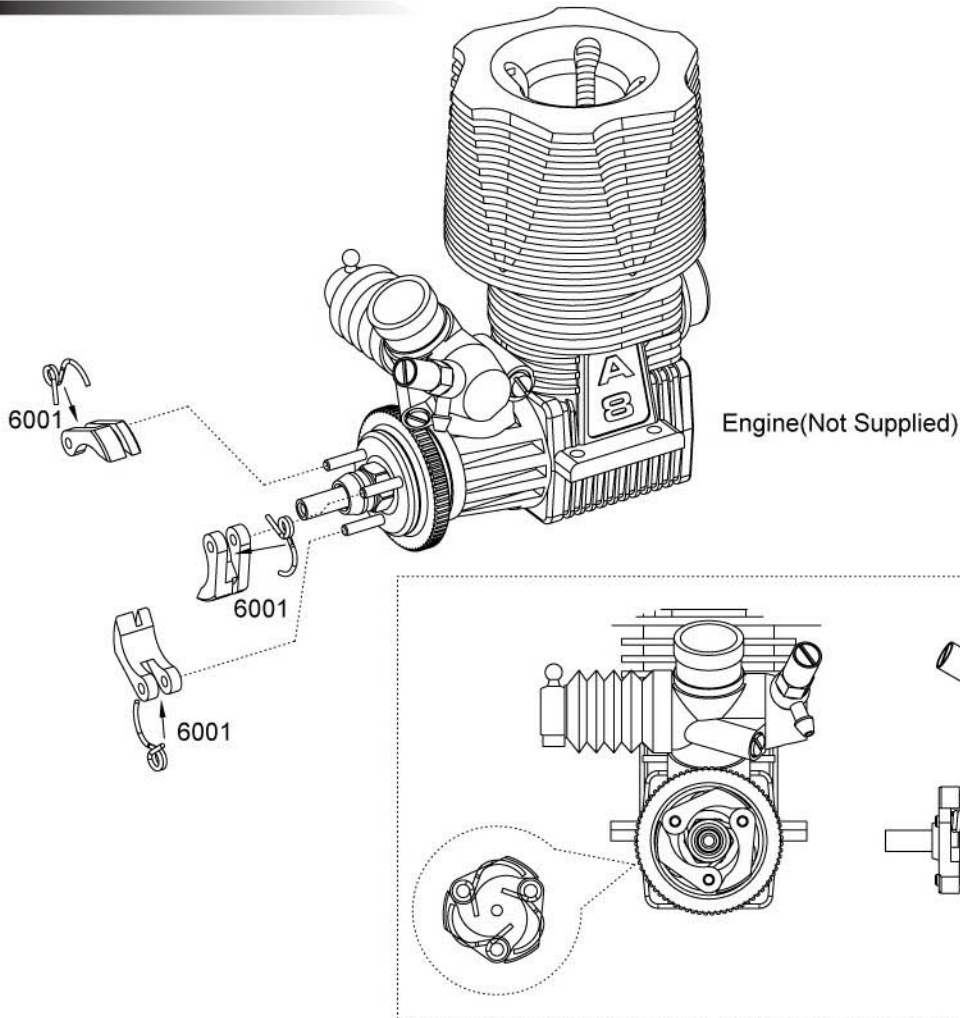

STEP 1-3

Clutch Bell Assembly

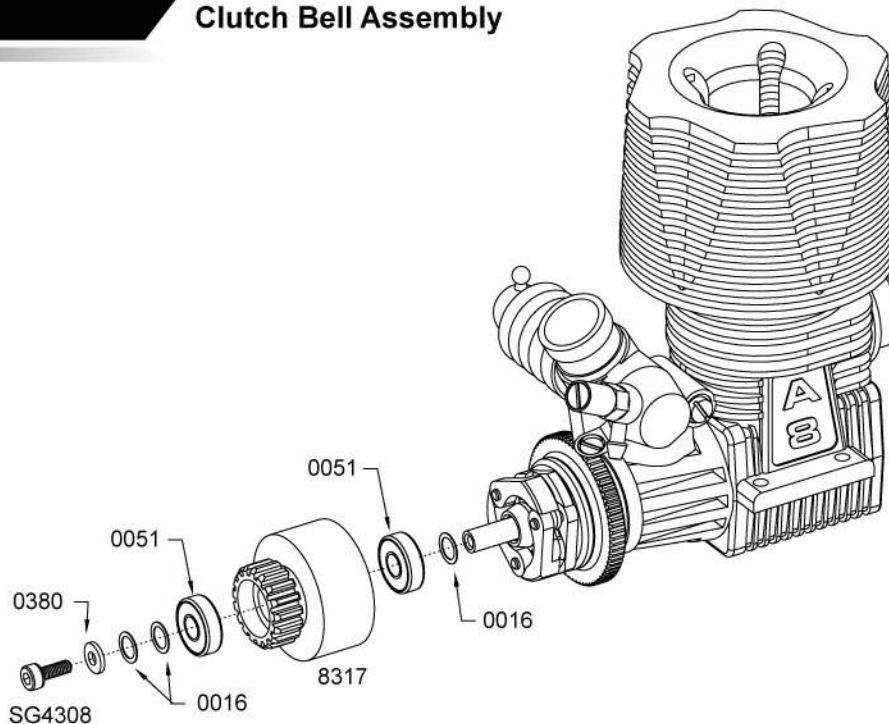

STEP 1-4

Engine Mount Assembly

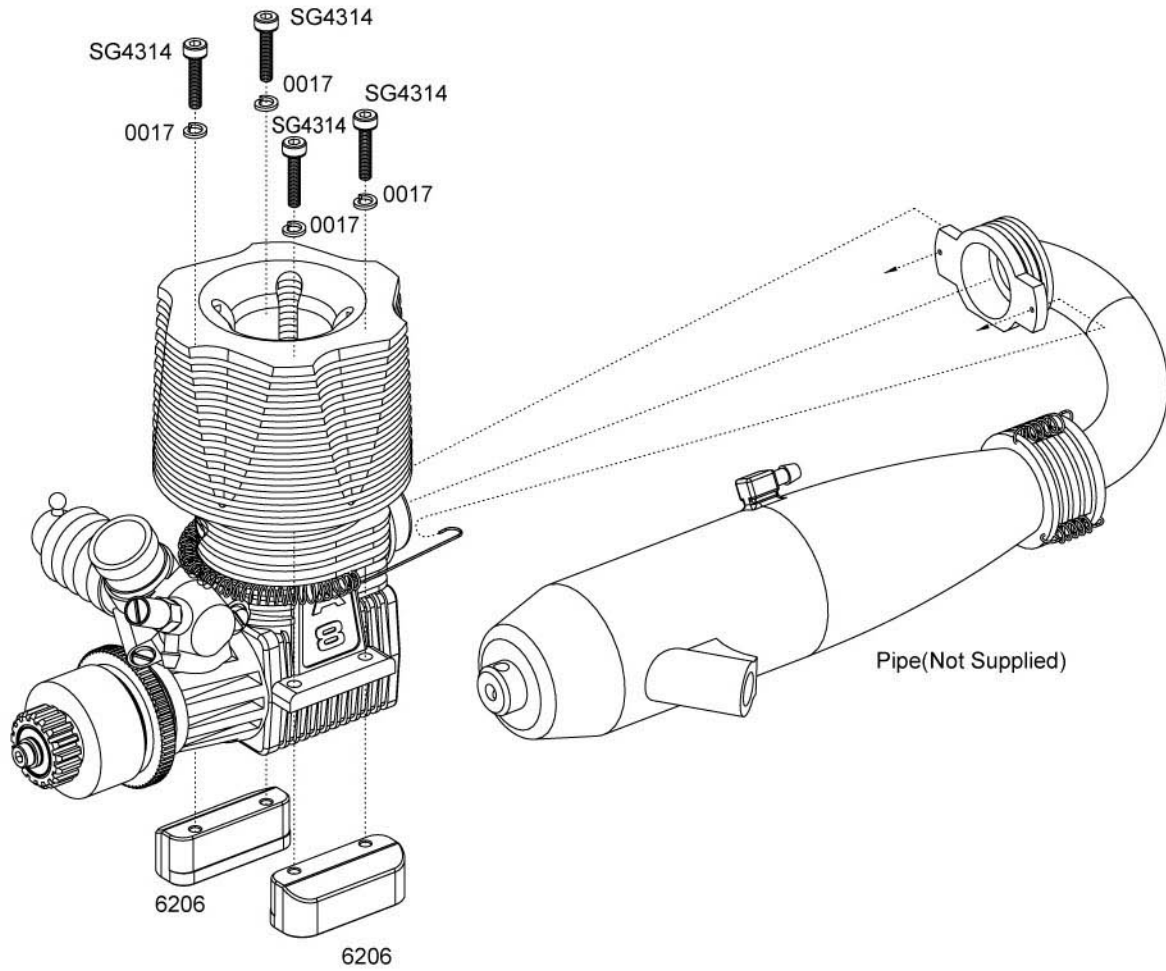

STEP 1-5

Engine Mount Assembly

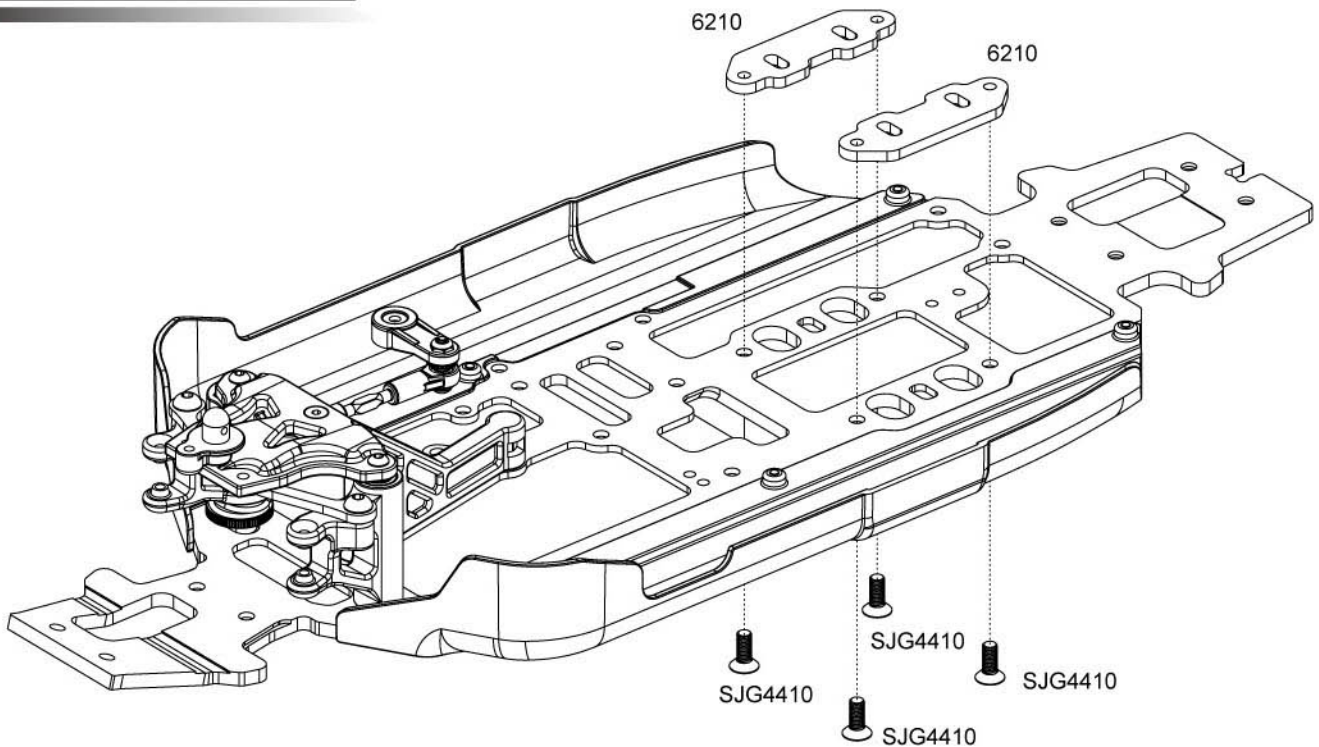

STEP J-1

Servo Saver Installation

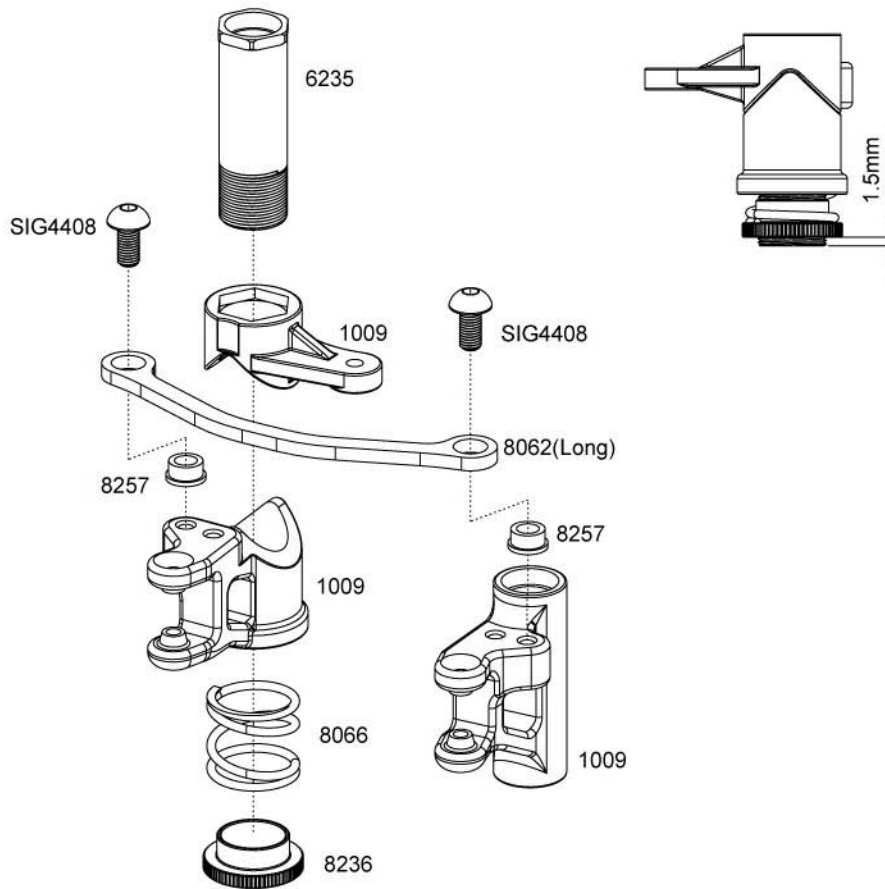

STEP J-2

Steering Servo Link Assembly

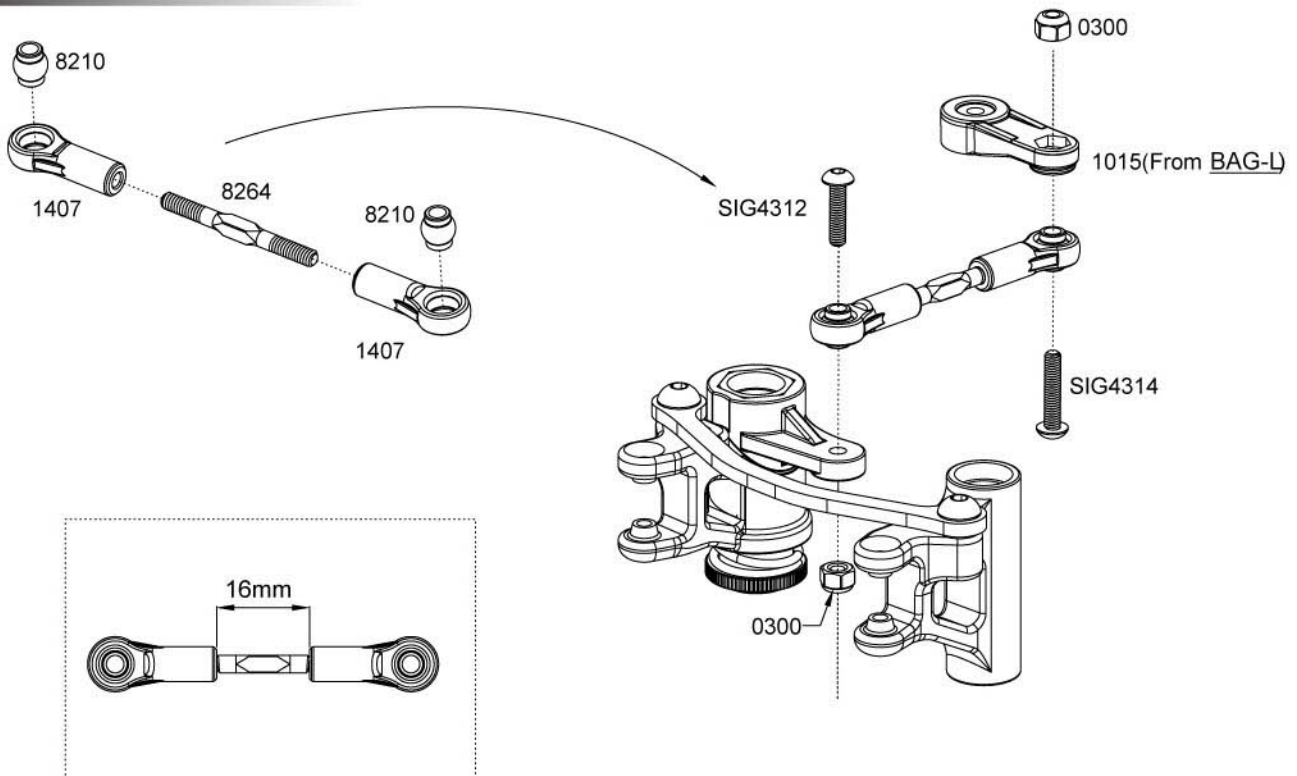

STEP J-3

Steering Post & Front Chassis Support Assembly

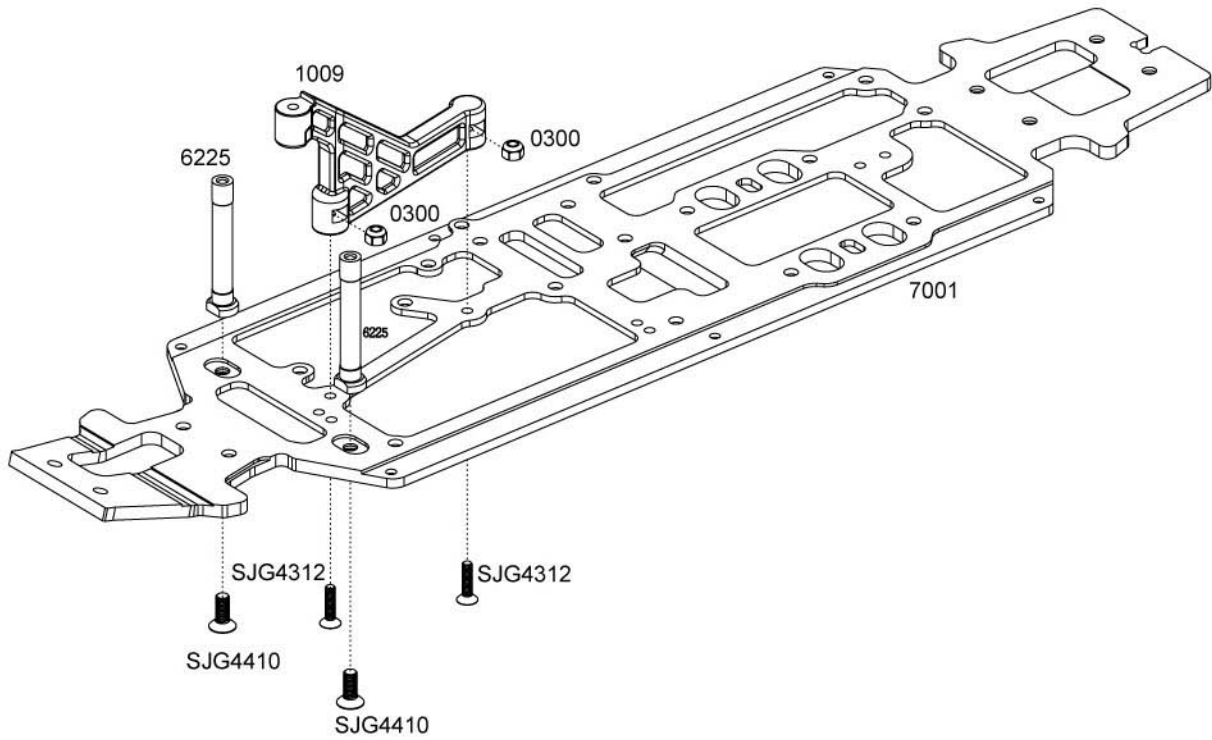

STEP J-4

Steering Saver & Front Chassis Brace Assembly

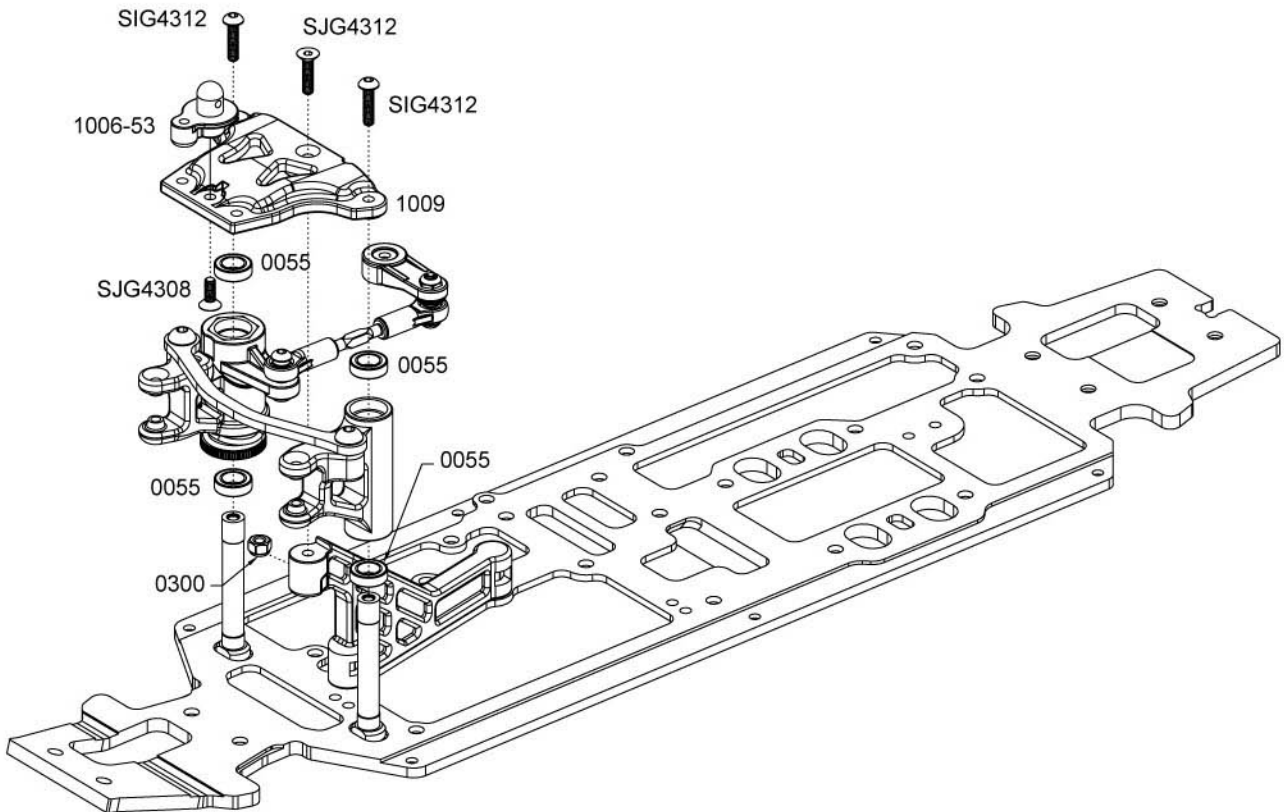

STEP J-5

Completed Steering Assembly

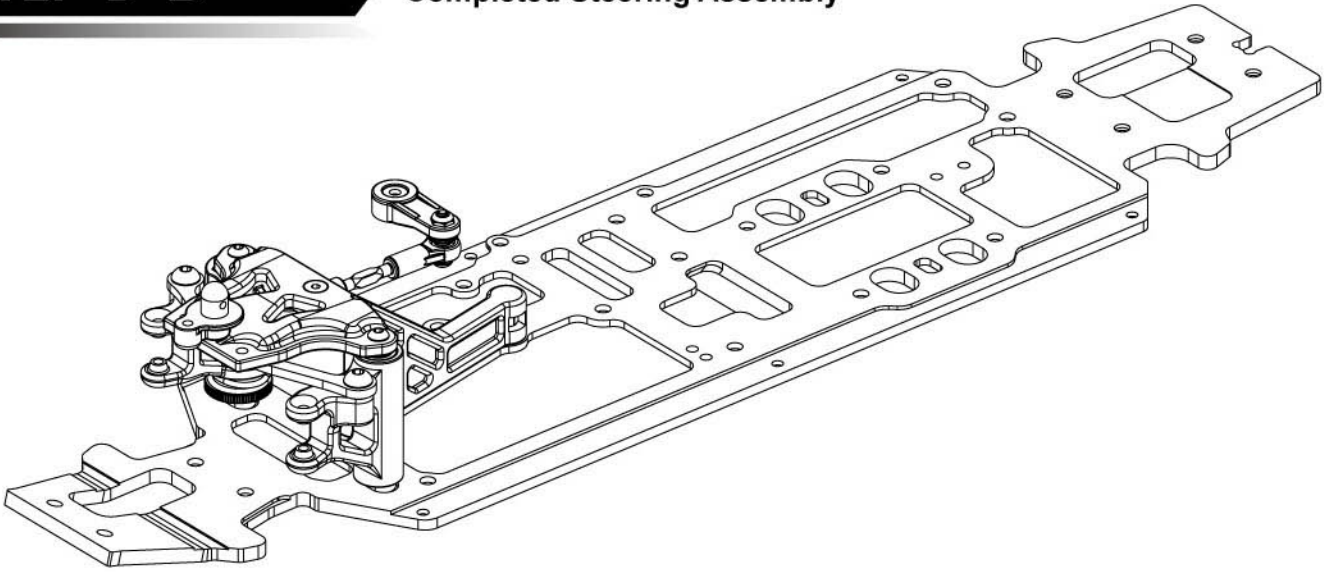

BAG K

STEP K-1

Chassis Guard Installation

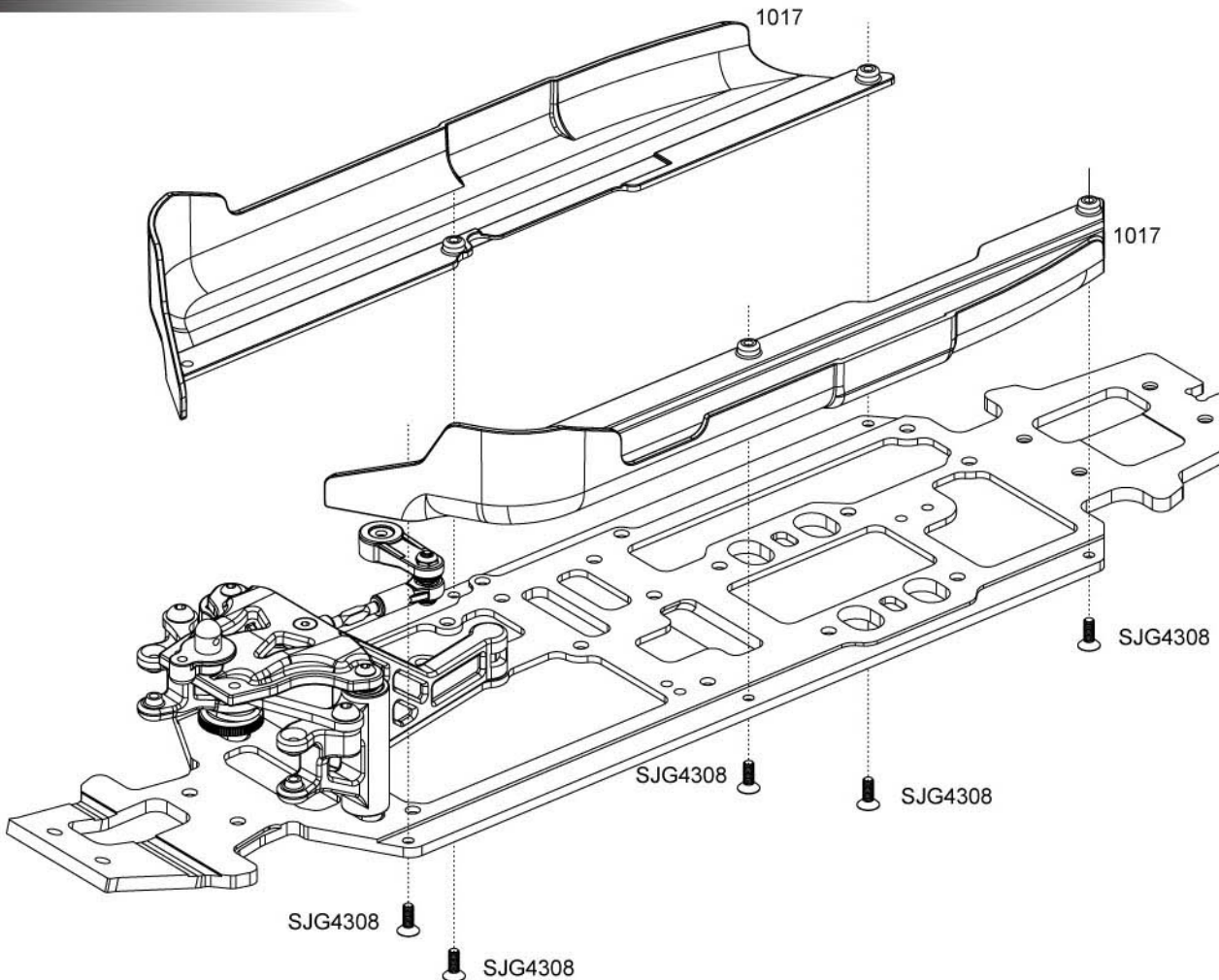

STEP L-1

Throttle/Brake Linkage Assembly

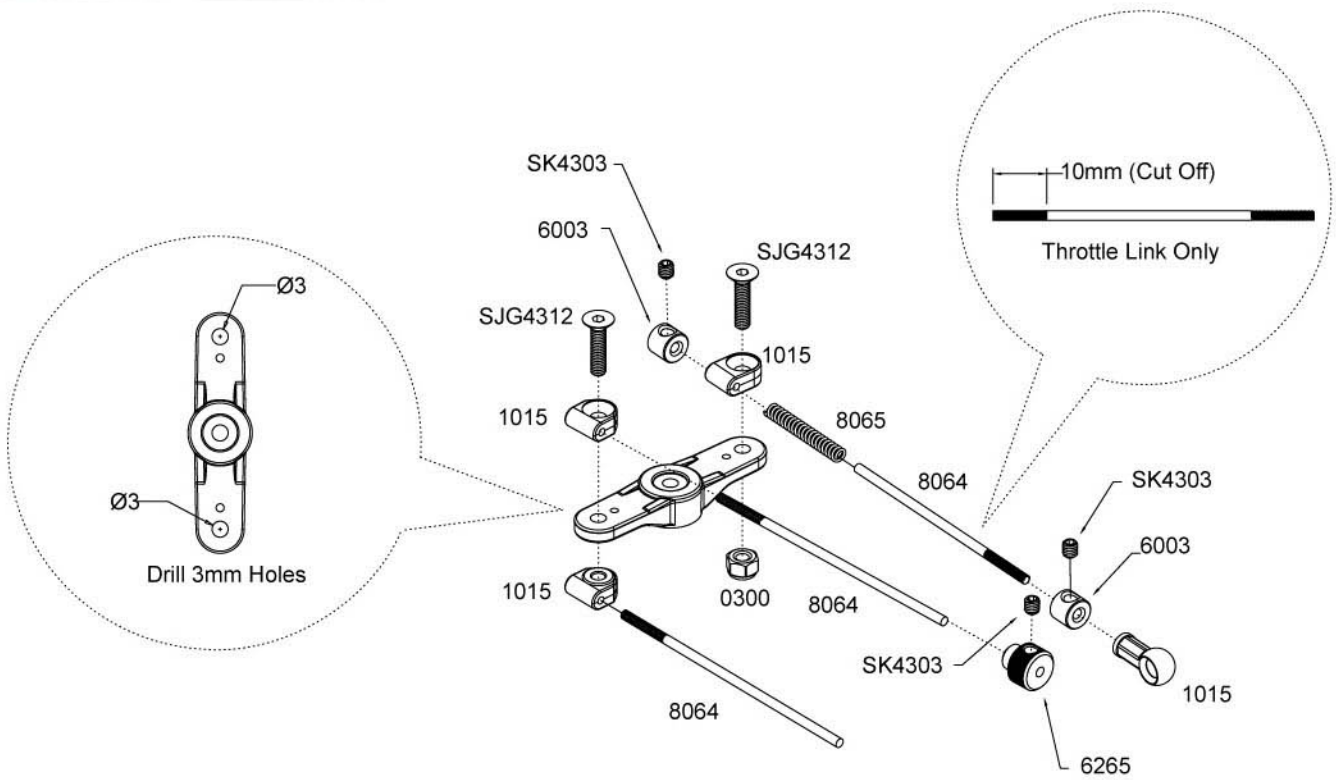

STEP L-2

Completed Throttle/Brake Assembly

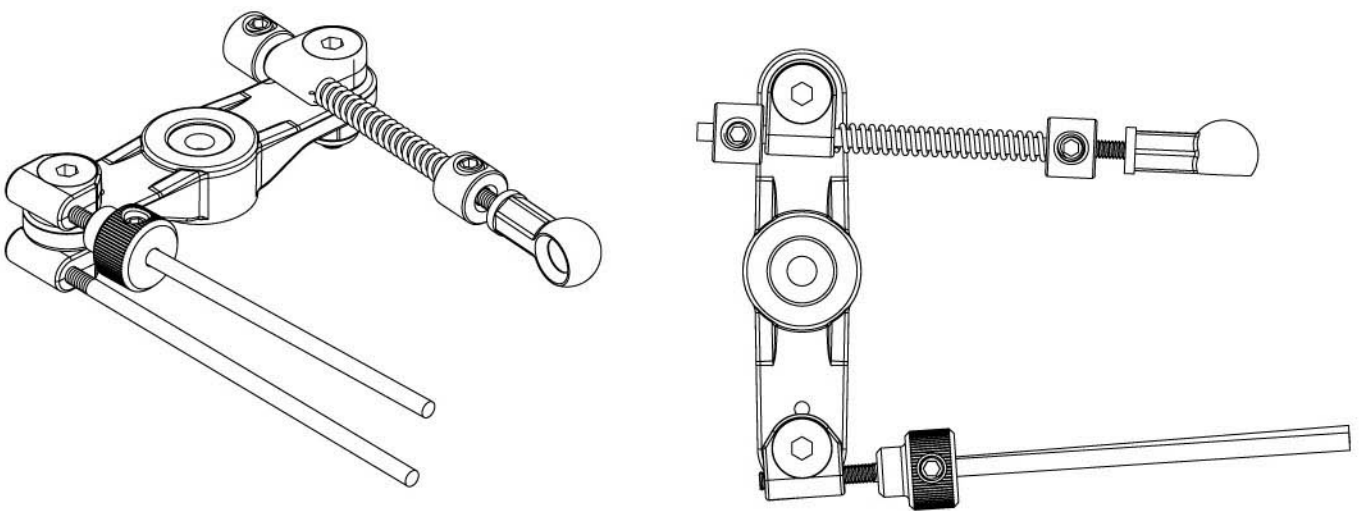

STEP M-1

Air Filter Assembly

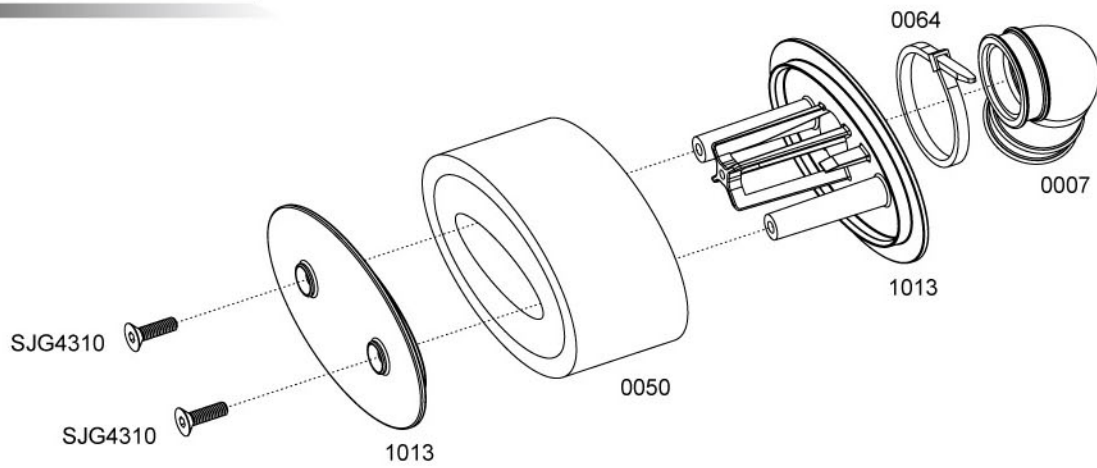

STEP M-2

Air Filter Assembly

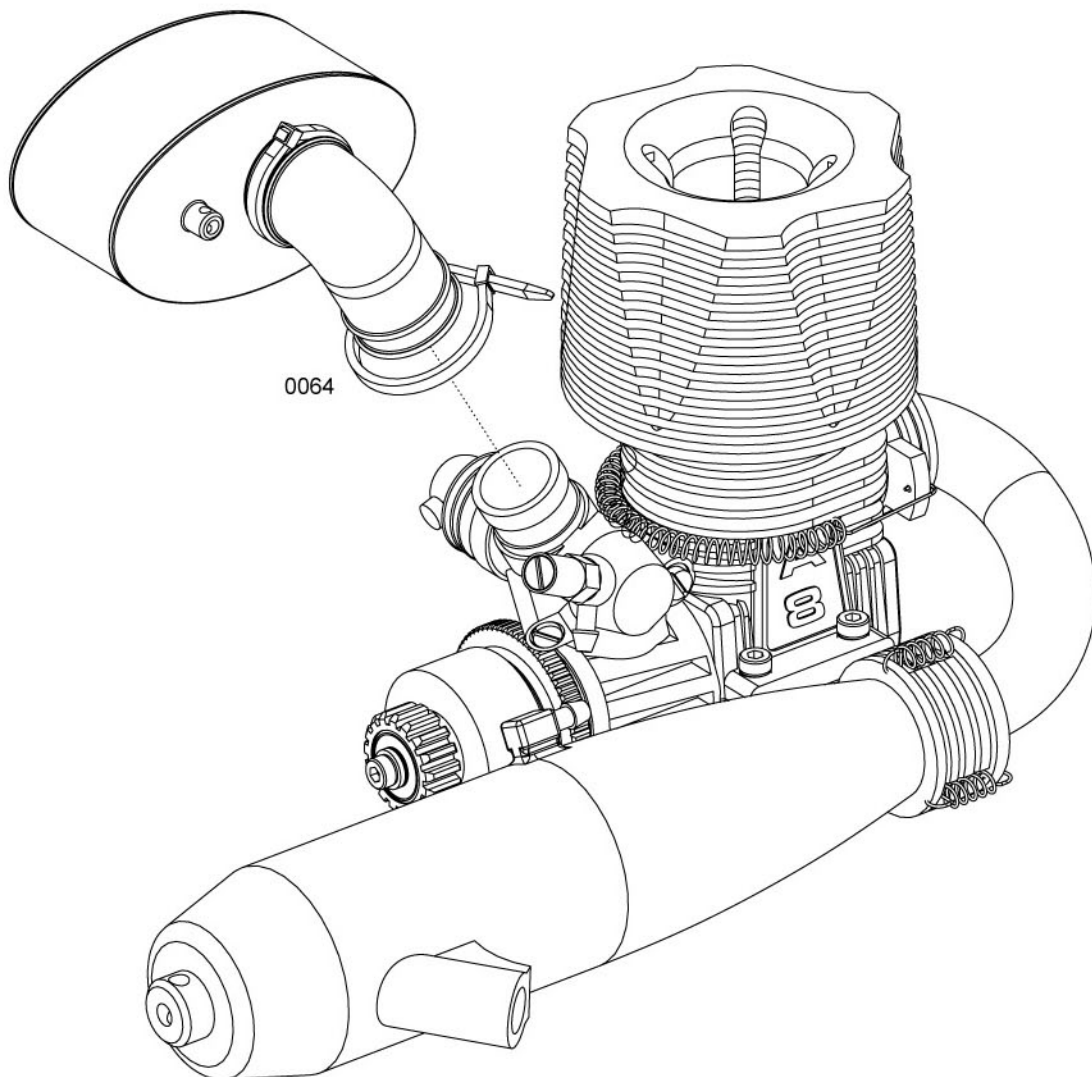

STEP - 1

Center Diff Install

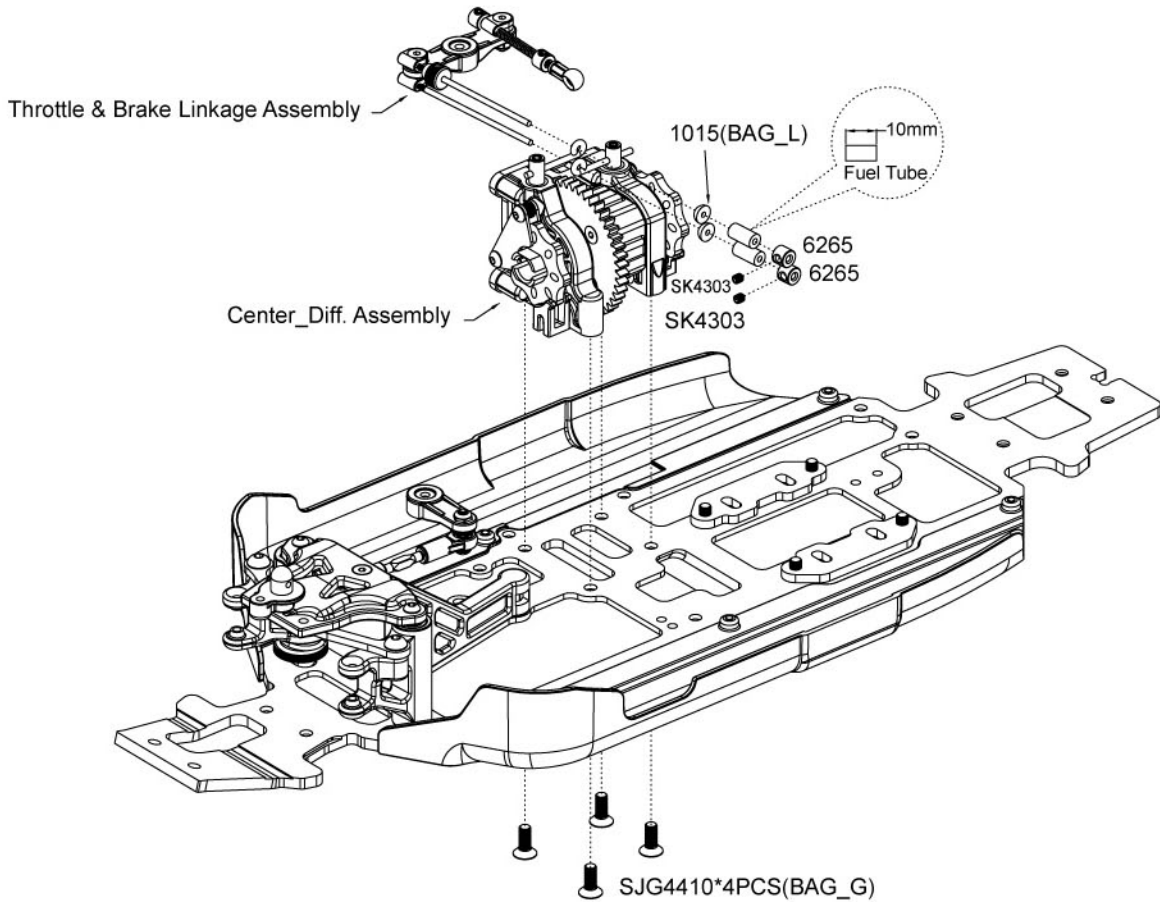

STEP - 2

Front End Install

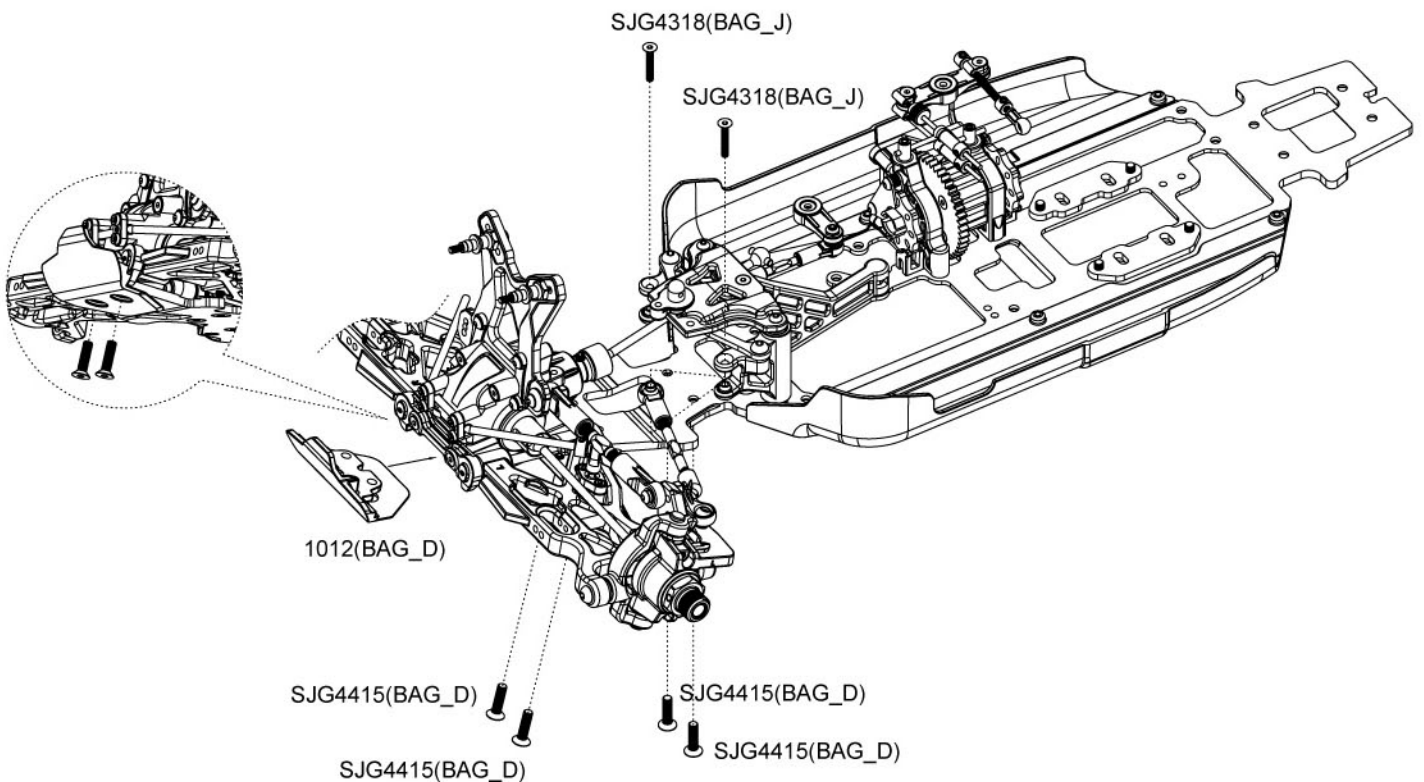

STEP - 3

Front End Installation

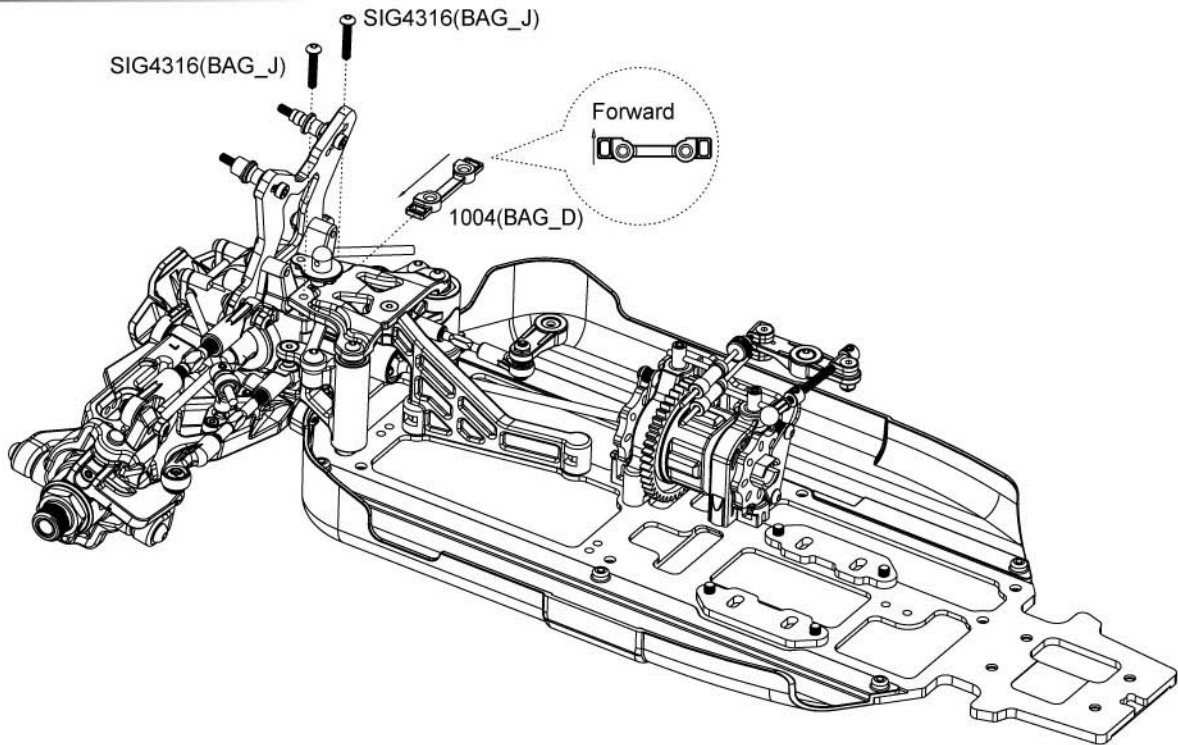

STEP - 4

Front End Installation

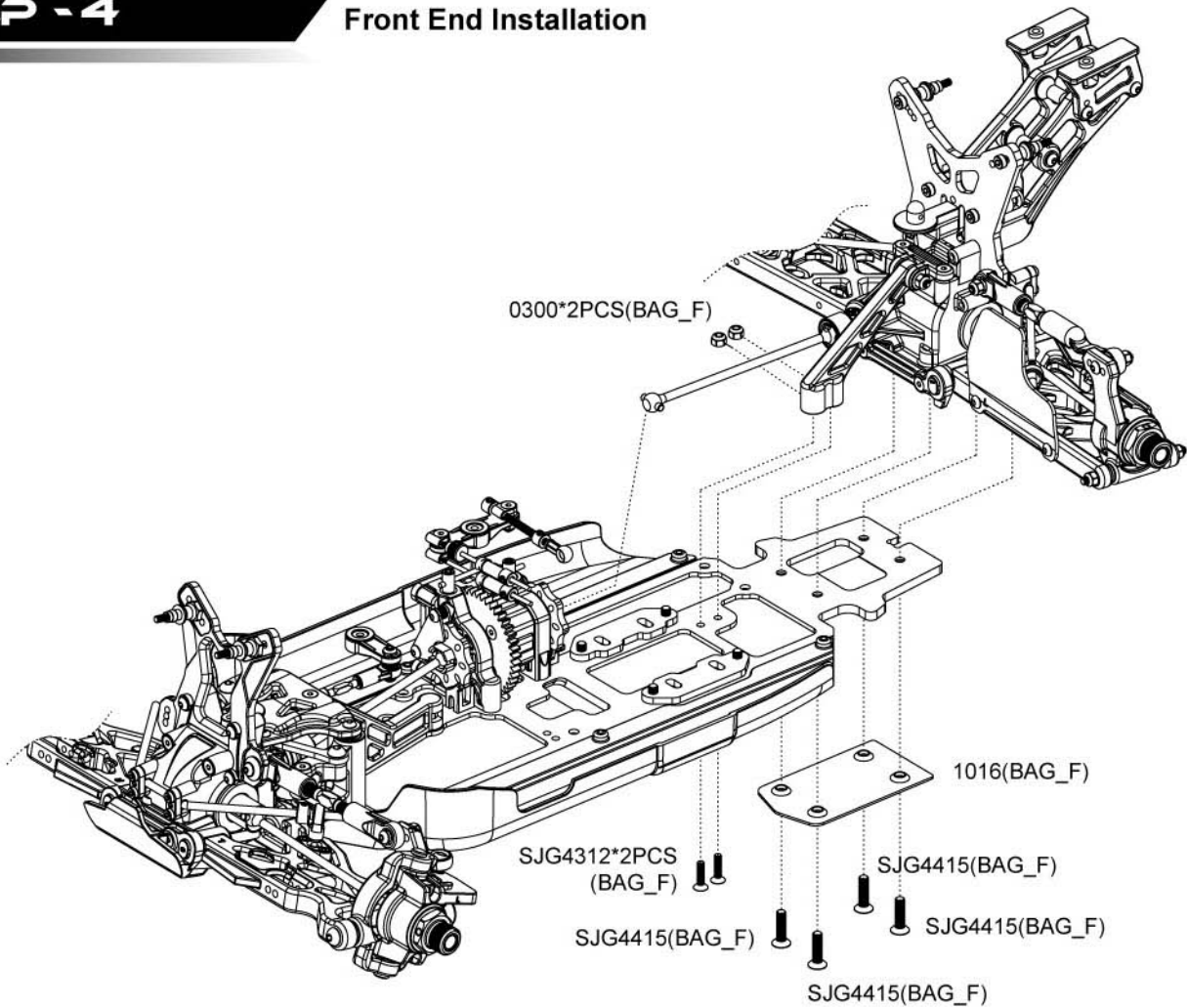

STEP - 6

Engine Set Install

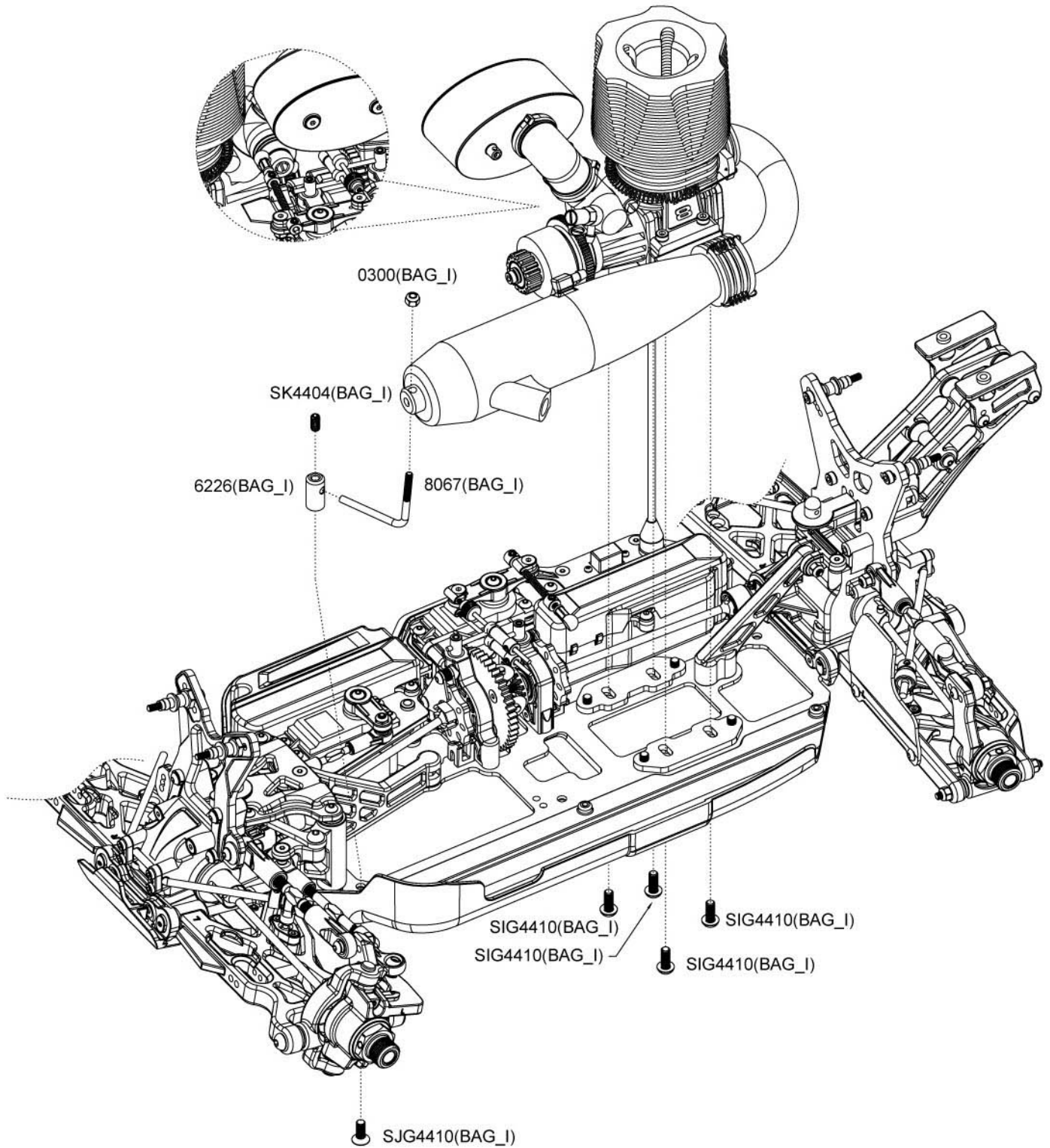

STEP - 7

Fuel Tank Install

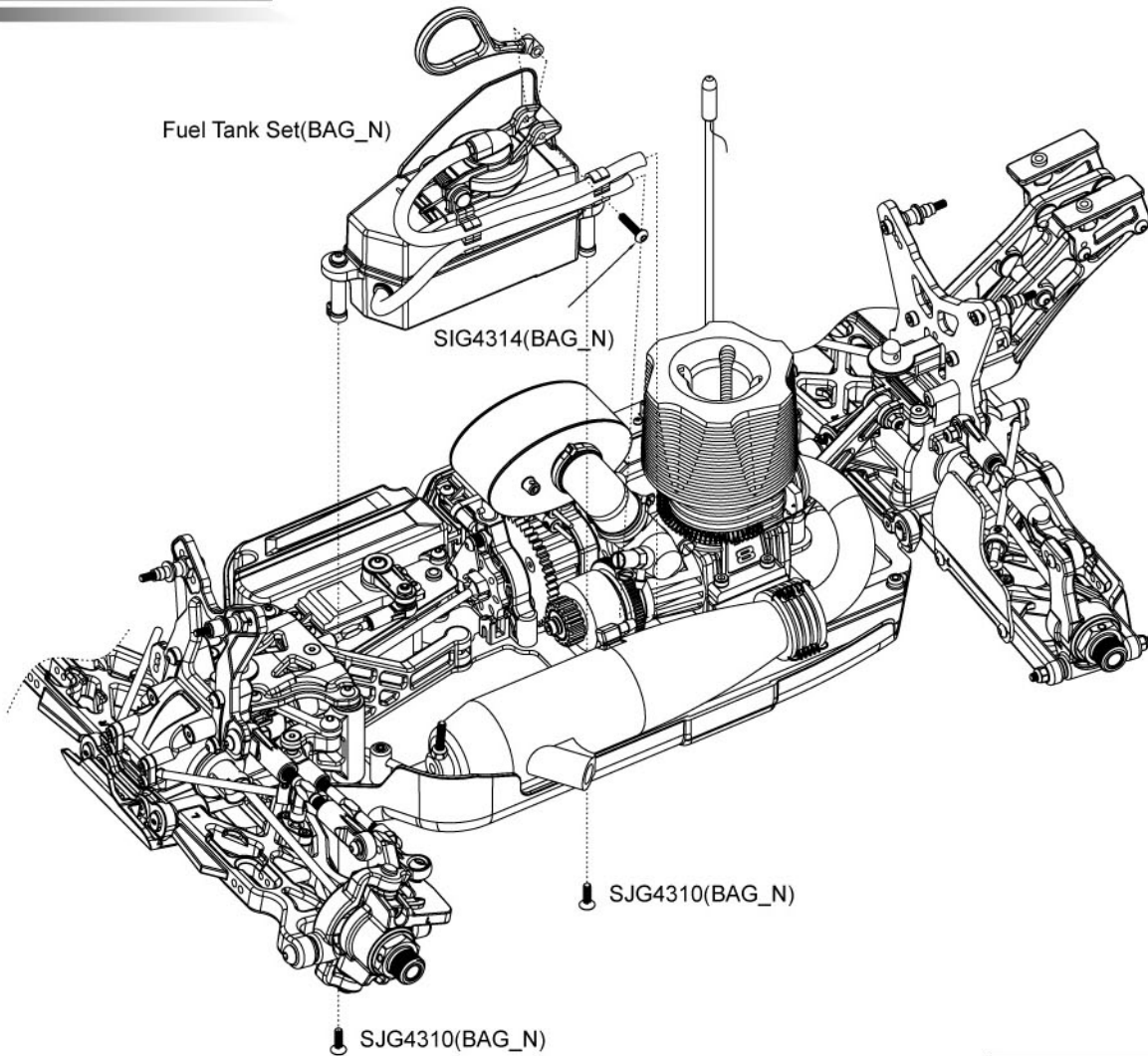

STEP - 8

Front/Rear Shock Install

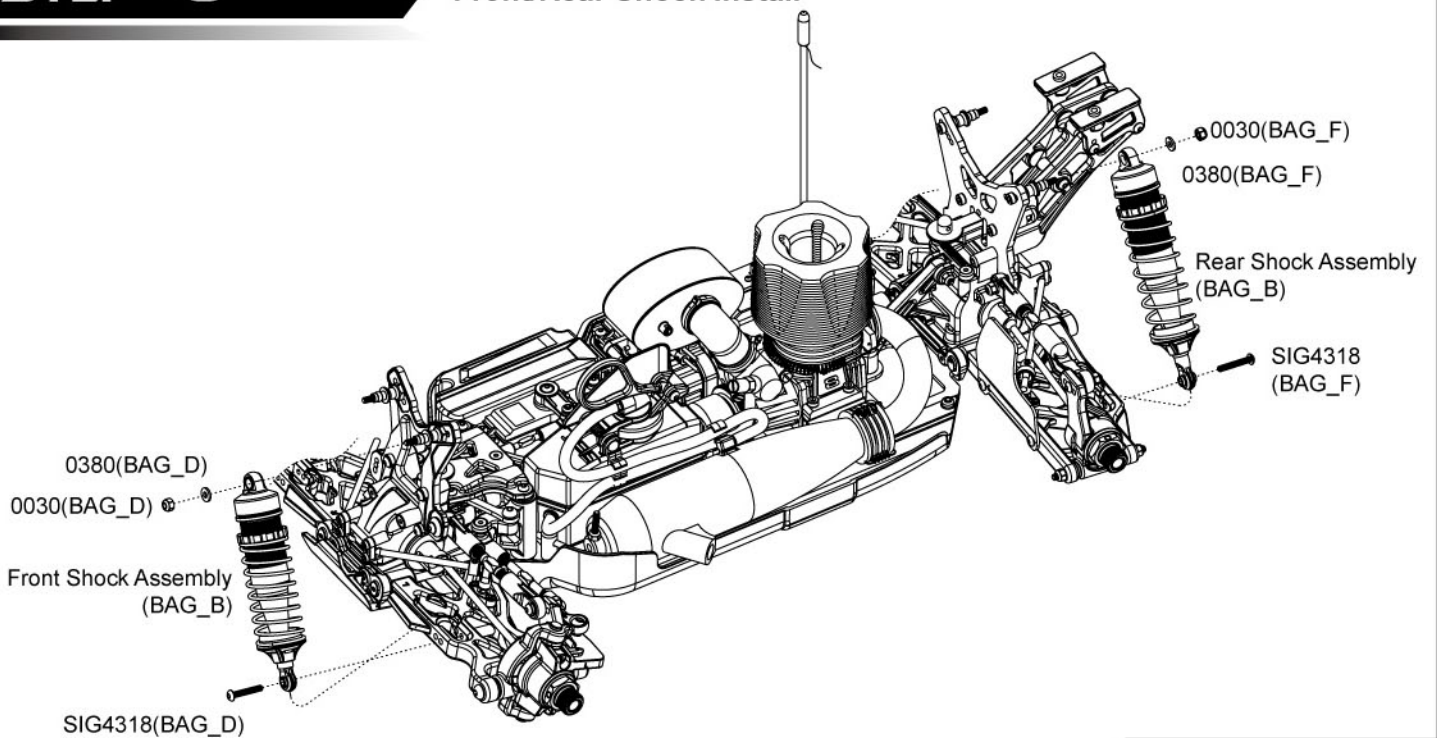

STEP - 9

Tire Install

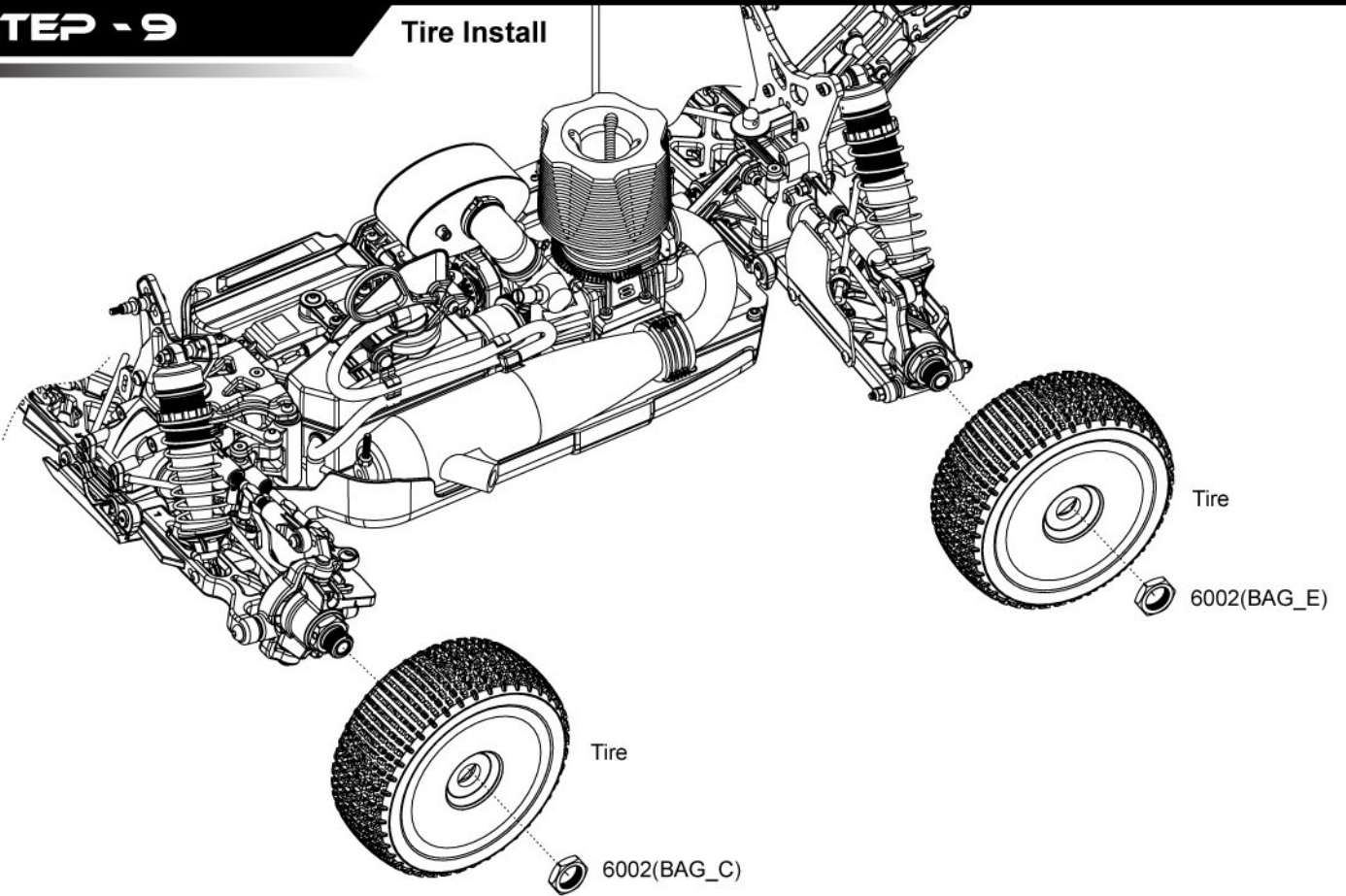

STEP - 10

Win Install

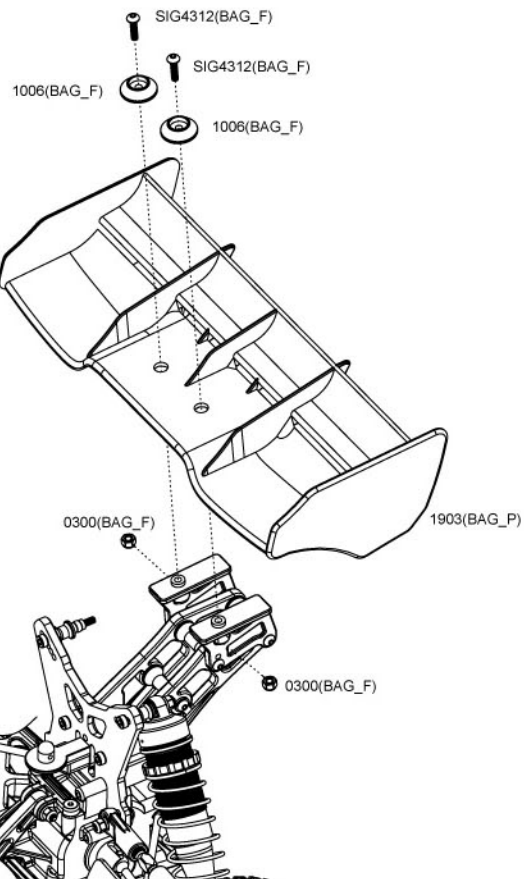

STEP - 11

Body Mounting

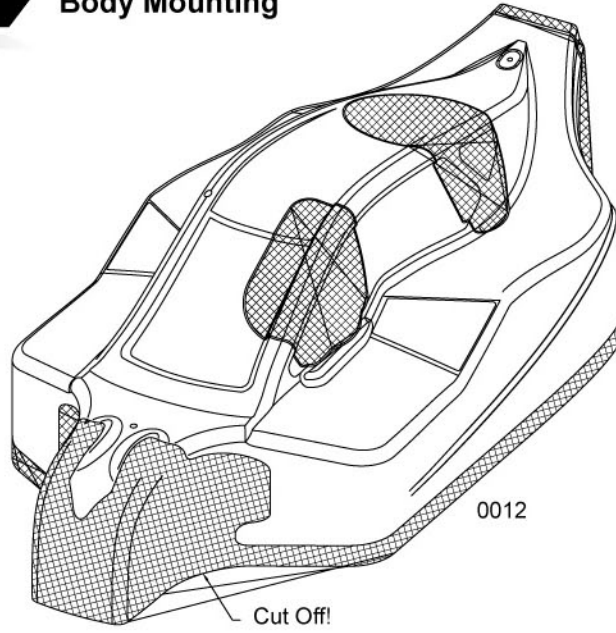

STEP - 12

Body Mounting

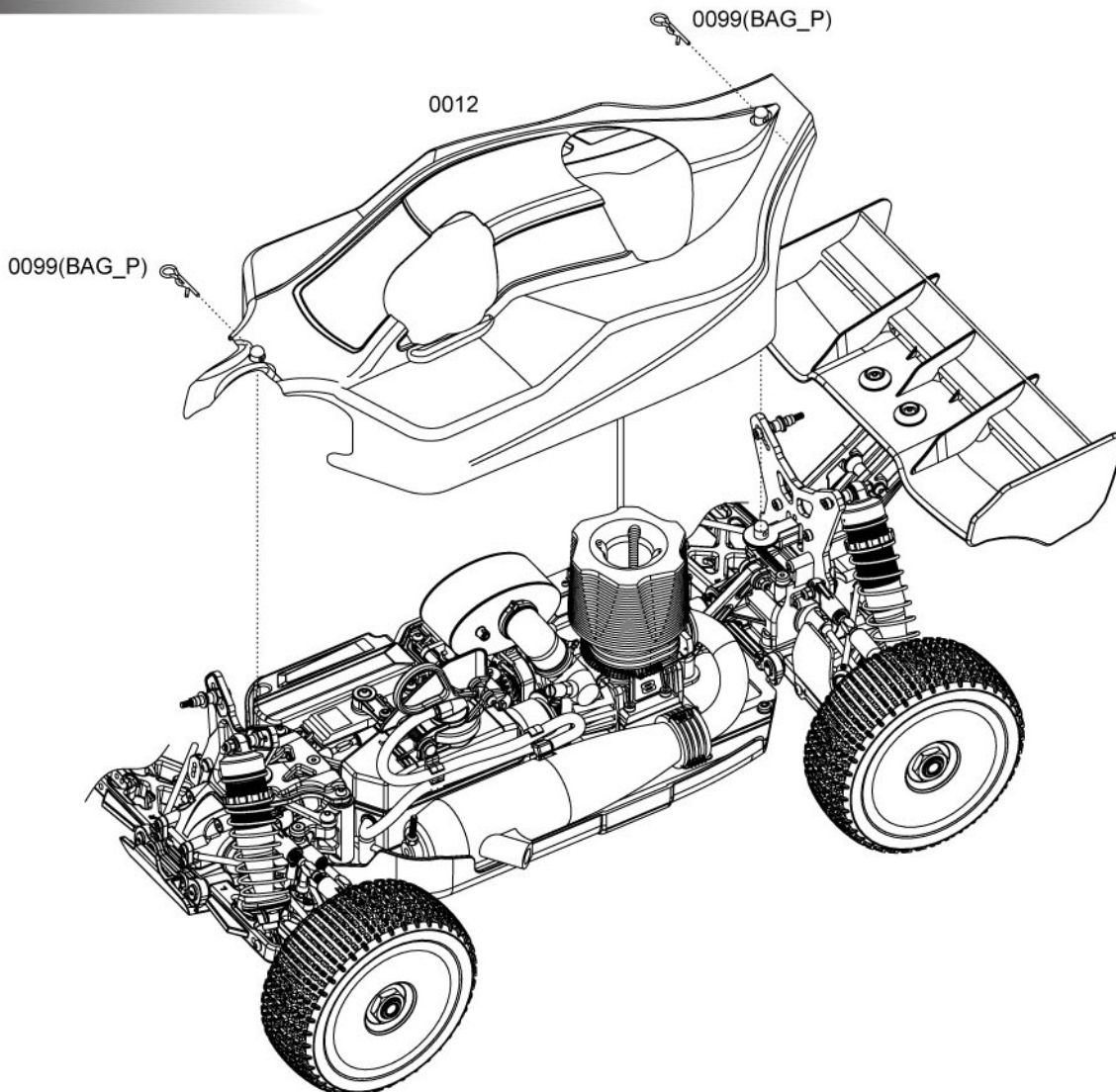

TRACK CONDITIONS Indoor Tight Smooth Hard Packed Blue Groove

Wet Low Bite High Bite Outdoor Open Rough Loose/Loamy

Dry Dusy Wed Bite Other _____

ENGINE Gasket mm Plug Muffler Fuel

Clutch bell 16T 17T 18T Other _____ T Shoes 3 4 Spring mm

DIFF Front Oil # Center Oil # Rear Oil #

_____ T x _____ T Spur gear T _____ T x _____ T

FRONT SUSPENSION

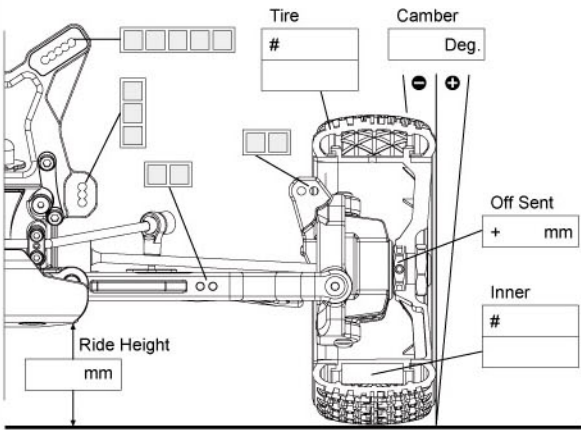

FRONT TOE ANGLE

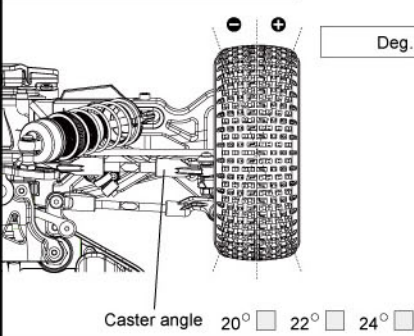

FRONT SHOCK

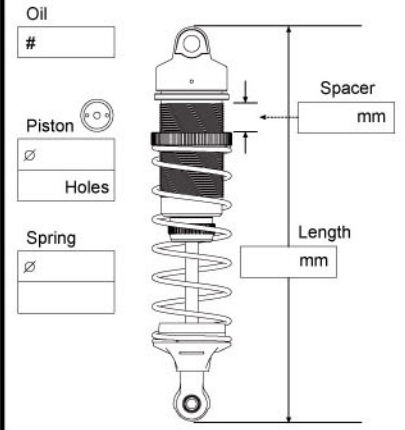

KICK UP



ANTI-ROLL BAR

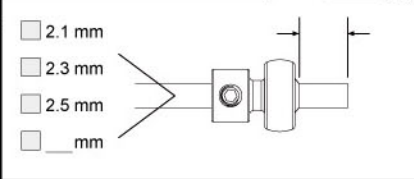

REAR SHOCK

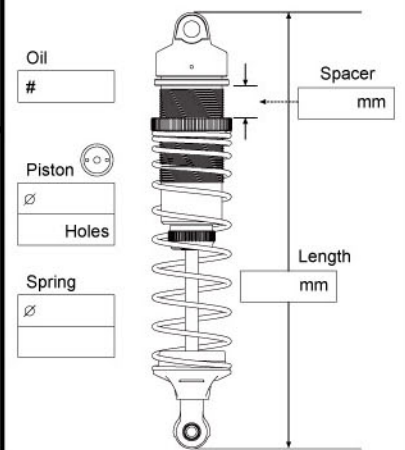

ANTI SQUAT



TOE ANGLE

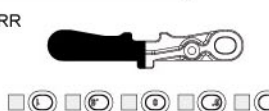

WHEEL BASE

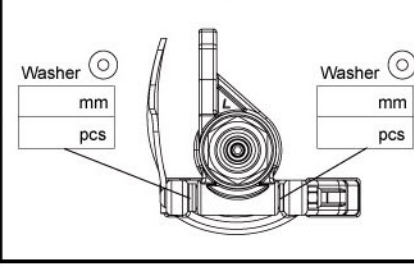

REAR SUSPENSION

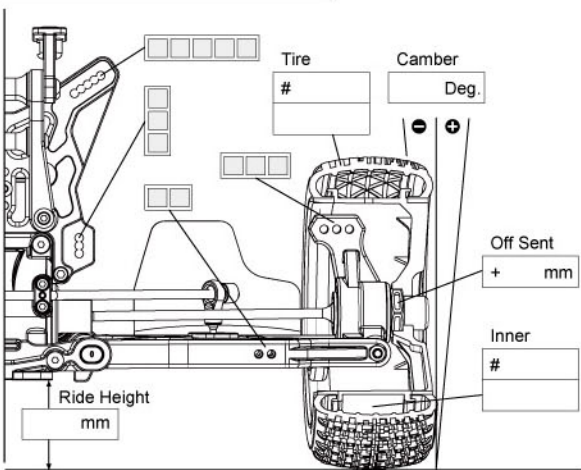

WING POSITION



ANTI-ROLL BAR

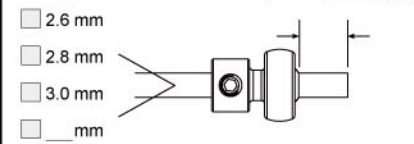

DOWNSTOP

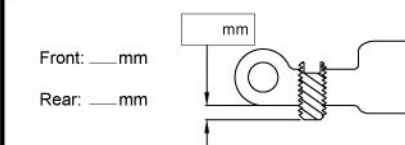

ACKERMAN

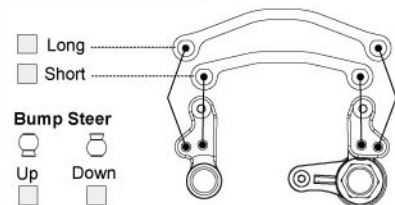

RECEIVER BATTERY

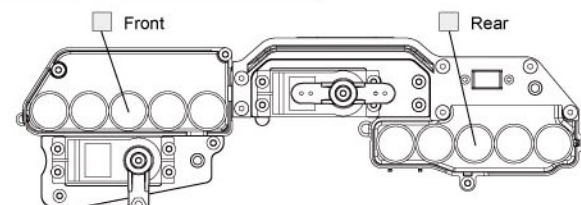

THROTTLE SERVO

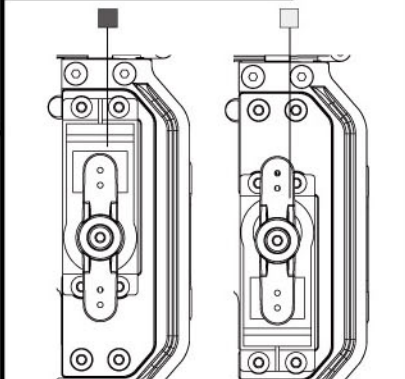

Item	Description	Item	Description	Item	Description
BAG A-1		6253	2 Shock caps bottom	1002	1set Front lower arm
SJG4312	4 Screw 3*12	6254	2 Shock cap top	1207	2 Link for stabilizer
0001	1 Diff gasket	8060	2 Front spring	8215	2 Arm link ball
0002	2 Diff O-ring	8250	2 Shock shaft front	8224	4 Front suspension arm pushing
0013	2 washerØ6*12*0.2	BAG B-2		8214	2 Link ball for stabilizer
0053	2 Ball bearing 8*16*5	0004	2 Dust rubber	BAG D-1	
1200	1 Diff case	1112	4 Damper end parts	8910	1 F/R diff pinion gear 10T
8056	2 PINØ2.5*11.8	1212	2 Shock end tray	0051	2 Ball bearing 5*13*4
8219	2 Cup joint	1312	2 Damper cap bush	1004	1set Front gear box
8242	2 Shaft of planetary	6252	2 Shock adjuster nuts	8237	1 F/R diff pinion coupler caps
8710	4 Diff gear 10T	6253	2 Shock caps bottom	8243	1 F/R diff pinion couplers
8720	2 Diff gear 20 T	6254	2 Shock cap top	8057	1 Pin 2.5*12.6
8943	1 Front Diff. ring gear 43T	6249	2 Rear shock body	8216	1 CVD assy
BAG A-2		8061	2 Rear spring	8217	1 Center drive shaft
SJG4312	4 Screw 3*12	8251	2 Shock shaft rear	1012	1 Front bumper
0001	1 Diff gasket	BAG B-3		SK4406	1 Set screw 4*6
0002	2 Diff O-ring	0003	2 Diaphragm	SJG4415	4 Screw 4*15
0013	2 washerØ6*12*0.2	0008	4 Shock O-ring	BAG D-2	
0053	2 Ball bearing 8*16*5	0060	2 Oil seal cap O-ring	SJG4320	2 Screw 3*20
1200	1 Diff case	0061	2 Damper O-ring	SIG4314	2 Screw 3*14
8056	2 PINØ2.5*11.8	0091	2 Shock piston guide set	0014	2 Washer 13.5*15.8*0.2
8219	2 Cup joint	0092	2 Shock piston guide set	SJG4314	4 Screw 3*14
8242	2 Shaft of planetary	0096	2 Piston	8227	2 Hinge pin 4mm
8710	4 Diff gear 10T	0300	2 3mm nylon nuts	1116	4 Hubs
8720	2 Diff gear 20 T	0360	2 Washer 3*6*0.5	7201	1 Front hinge pin brace
8843	1 Rear Diff. ring gear 43T	8210	2 Shock ends ball bearing	7202	1 Front-rear hinge pin brace
BAG A-3		BAG C-1		SK4303	4 Set screw 3*3
SJG4312	4 Screw 3*12	1011	2 Front spindles	SG4256	4 Screw 2.5*6
0001	1 Diff gasket	0053	2 Ball bearing 8*16*5	8051	1 Anti-roll barØ2.3
0002	2 Diff O-ring	0054	2 Ball bearing 1/2*3/4*5/32	BAG D-3	
0013	2 washerØ6*12*0.2	8217	2 Center drive shaft	7220	1 Shock tower front
0052	2 Ball bearing 8*14	8218	2 Wheel axles	SIG4314	4 Screw 3*14
1200	1 Diff case	8216	2 CVD assy	SIG4318	8 Screw 3*18
8045	1 center Diff. 45T spur gear	8057	2 Pin 2.5*12.6	6246	2 Aluminum washer
8056	2 Pin 2.5*11.8	8058	2 Pin 3*16.8	8232	2 Shock stand offset
8228	2 cup joint center	6229	2 Wheel hexagon	SG4325	2 Screw 3*25
8242	2 Shaft of planetary	SK4505	2 Set screw 5*5	0300	6 3mm nylon nuts
8710	4 Diff gear 10T	6002	2 Wheel nuts	1007	4 Upper arm link
8720	2 Diff gear 20T	BAG C-2		8211	4 Pivot ball Ø6.9mm
BAG B-1		1111	2 Front spindle carriers	8220	2 Front turnbuckles
0004	2 Dust rubber	8223	4 Suspension pin	0380	2 Washer 3*8*0.7
1112	4 Damper end parts	SK4306	4 Set screw 3*6	 	
1212	2 Shock end tray	BAG C-3			
1312	2 Damper cap bush	SK4408	2 Set screw 4*8		
6248	2 Front shock body	SG4258	4 Screw 2.5*8		
6252	2 Shock adjuster nuts	SIG4414	4 Screw 4*14	 	

Item	Description	Item	Description	Item	Description
BAG D-4		SJG4310	2 Screw 3*10	BAG H	
8213	2 Pivot ball Ø6.9mm	SJG4314	2 Screw 3*14	1008	1set 16pcs Radio box
1307	4 Rod end	7203	1 Rear-front hinge pin brace	6208	1 Rotate aluminum plate
8222	2 Rotate turnbuckles	1116	4 Hubs (0.5*2) (1*2)	6209	1 Carburetor aluminum plate
8212	2 Pivot ball Ø6.9mm	8227	2 Hinge pin 4mm	0062	1 Antenna pipe & cover
0300	2 3mm nylon nuts	SIG4306	4 Screw 3*6	0063	1 Antenna set & cover
SJG4318	2 Screw 3*18	SK4303	4 Set screw 3*3	0005	1 Switch cover
BAG E-1		8053	1 Anti-roll barØ2.6	6241	1set 3pcs Antenna set
SK4505	2 Set screw 5*5	SG4256	4 Screw 2.5*6	SIG4316	8 Screw 3*16
6229	2 Wheel hexagon	BAG F-3		SIG4306	5 Screw 3*6
8058	2 Pin 3*16.8	SG4325	2 Screw 3*25	SJG 4308	4 Screw 3*8
0053	2 Ball bearing 8*16	SG4320	2 Screw 3*20	SJG4312	3 Screw 3*12
1010	1set Rear upright	1006	1set Wing stay	SJG 4410	6 Screw 4*10
0054	2 Ball bearing 1/2*3/4*5/32	8232	2 Shock stand offset	SK 4303	1 Set Screw 3*3
8218	2 Wheel axles	0300	6 3mm nylon nuts	SIG 4310	3 Screw 3*10
8057	2 Pin 2.5*12.6	1507	3 Wing stay brace	Item Description	
8216	2 CVD assy	SIG4312	8 Screw 3*12	BAG I-1	
8217	2 Center drive shaft	0380	4 Washer 3*8*0.7	6001	1set Clutch set
6002	2 Wheel nuts	SIG4310	2 Screw 3*10	BAG I-2	
BAG E-2		7221	1 Shock tower rear	6244	1set Flywheel
1003	1set Rear lower arm	BAG F-4			Bushing
0300	4 3mm nylon nuts	1009-16	1 F/R brace set		Flywheel nut
8238	2 Hinge pin studs	SIG4318	7 Screw 3*18	SG4308	1 Screw 3*8
1207	2 Link for stabilizer	0300	7 3mm nylon nuts	0380	1 Washer 3*8*0.7
8214	2 Link ball for stabilizer	SIG4314	4 Screw 3*14	0051	2 Ball bearing 5*13*4
SG4258	4 Screw 2.5*8	6246	2 Aluminum washer	0016	3 Washer 5*7*0.2
8215	2 Arm link ball	8211	4 Pivot ball Ø6.9mm	8017	1 Clutch bell 17T
SK4408	2 Set screw 4*8	1007	2 Upper arm link	BAG I-3	
BAG F-1		1107	2 L upper arm link	6210	2 Engine mount retainer
8910	1 F/R diff pinion gear 10T	8221	2 Rear turnbuckles	6206	2 Engine mount
0051	2 Ball bearing 5*13*4	SJG4312	2 Screw 3*12	SG4314	4 Screw 3*14
1005	1set Rear gear box	BAG G		SIG 4410	4 Screw 4*10
8237	1 F/R diff pinion coupler caps	6234	2 Front brake cam	SJG4410	6 Screw 4*10
8243	1 F/R diff pinion couplers	1014	6 Center diff mount		4 Gap washer 3*5
8057	1 Pin 2.5*12.6	SK4306	2 Set screw 3*6	BAG I-4	
SK4406	1 Set screw 4*6	SJG4308	2 screw 3*8	6226	1set Muffler stay
8216	1 CVD assy	8059	2 Brake steel stick	0300	1 3mm nylon nuts
8217	1 Center drive shaft	SK4303	2 Set screw 3*3	8067	1 Steel stick
1016	1 Rear bumper	6266	2 Brake piston	SJG4410	1 Screw 4*10
SJG4415	4 Screw 4*15	0010	4 Brake clip	SK4404	1 Set screw 4*4
BAG F-2		0011	4 Brake clip spring		
SJG4345	2 Screw 3*45	0009	2 Brake disk		
7204	1 Rear-rear hinge pin brace	SIG4312	4 Screw 3*12		
SJG4320	2 Screw 3*20	7207	1 Aluminum Diff mount		
0014	2 Washer 13.5*15.8*0.2	SJG4308	4 Screw 3*8		
1009-18	1 Front upper plate	SJG4410	4 Screw 4*10		

Item	Description	Item	Description	Item	Description
BAG J-1		0050	1 Air filter foam		
6235	1 Steering over-ride hardware	0064	2 Strap		
1019	3 Steering set	BAG N			
8066	1 Over-ride spring	1001	1 Fuel tank		
8236	1 Steering over-ride nuts		1 Ring pull for fuel tank		
8257	2 Bushing	SJG4310	2 Screw 3*10		
SIG4408	2 Screw 4*8	SIG4314	1 Screw 3*14		
8062	1 Steering rack (long)	BAG O			
8063	1 Steering rack (short)	7001	1 Chassis		
SJG4318	2 Screw 3*18	BAG P			
SIG4316	2 Screw 3*16		1 Wing		
BAG J-2		0099	2 R Pin		
8210	2 Shock ends ball bearing				
1407	2 Button head				
8264	1 Servo rotate turnbuckle				
0300	2 3mm nylon nuts				
SIG4312	1 Screw 3*12				
SIG4314	1 Screw 3*14				
BAG J-3					
6225	2 Bell crank shafts				
SJG4410	2 Screw 4*10				
SJG4312	3 Screw 3*12				
0300	3 3mm nylon nuts				
1009	2 Front upper plate & F/R brace set				
SJG4308	1 Screw 3*8				
0055	4 Ball bearing 6*10*3				
SIG4312	2 Screw 3*12				
BAG K					
1017	1 _{set} Stone guard				
SJG4308	5 Screw 3*8				
BAG L					
1015	1 _{set} Rotate servo set				
	2				
	1				
6003	4 Throttle/brake link				
6265	1 Throttle and brake linkage				
8064	3 Carburetor				
8065	1 Carburetor spring				
SK4303	5 Set screw 3*3				
SIG 4310	2 Screw 3*10				
0300	1 3mm nylon nuts				
SJG4312	2 Screw 3*12				
	2 Oil pipe 10 mm				
BAG M					
1013	2 Air clean set				
SJG4310	2 Screw 3*10				



LEAD YOU TO THE NEW GENERATION

www.agama-rc.com

U.J. ENTERPRISE CO., LTD.
E-mail: contact@agama-rc.com